



30 Court Hey Road

Childwall, Liverpool, L16 2LZ

£330,000



Nestled on the charming Court Hey Road in the desirable area of Childwall, Liverpool, this superbly presented semi-detached family home offers an inviting blend of comfort and style. With its double fronted façade, the property boasts an impressive presence that is sure to capture your attention.

Inside, you will find two spacious reception rooms, perfect for both entertaining guests and enjoying quiet family evenings. The well-appointed kitchen provides a functional space for culinary creations, while the adjoining conservatory allows for an abundance of natural light, creating a warm and welcoming atmosphere throughout the home.

The property features three generously sized bedrooms, providing ample space for family living or accommodating guests. The bathroom is thoughtfully designed, ensuring convenience and comfort for all residents.

One of the standout features of this home is the beautifully landscaped and secluded rear garden, offering a tranquil retreat for relaxation or outdoor gatherings. The garden is perfect for children to play or for hosting summer barbecues with friends and family. Additionally, off-road parking is available, providing ease and security for your vehicles.



Area Map

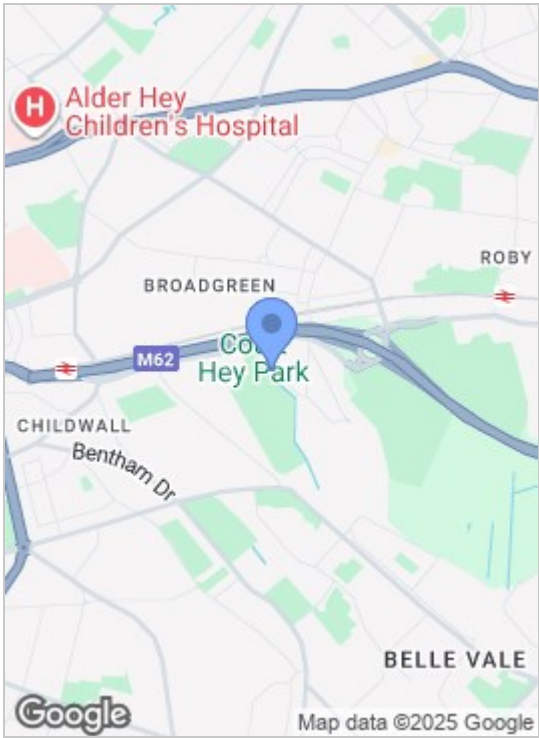

Floor Plans

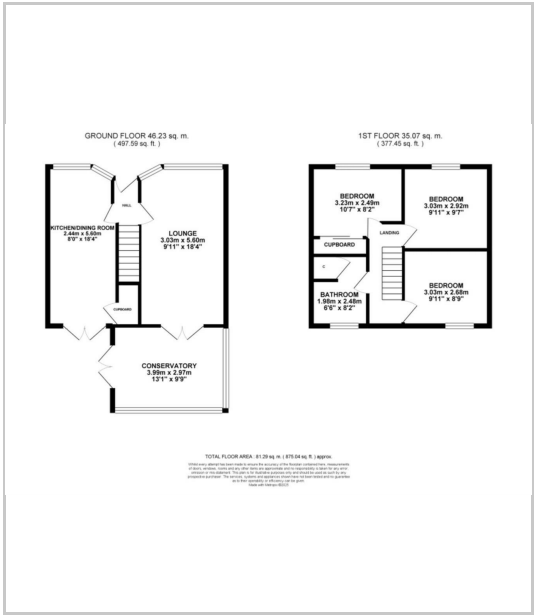

Energy Efficiency Graph

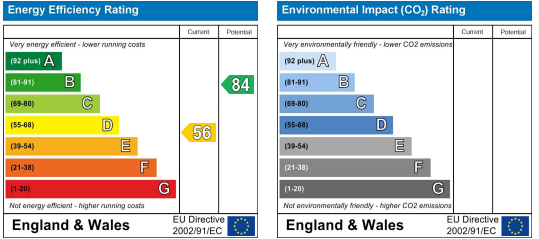

These particulars, whilst believed to be accurate are set out as a general outline only for guidance and do not constitute any part of an offer or contract. Intending purchasers should not rely on them as statements of representation of fact, but must satisfy themselves by inspection or otherwise as to their accuracy. No person in this firms employment has the authority to make or give any representation or warranty in respect of the property.

82 Coronation Road, Crosby, Liverpool L23 5RH

6 Allerton Road, Mossley Hill, Liverpool, L18 1LN

2 Chapel Lane, Formby, Liverpool, L37 4DU

Tel: 0151 909 3003

Tel: 0151 601 3003

Tel: 01704 827 402

Email: crosby@abode.group.co.uk

Email: allerton@abode-group.co.uk

Email: formby@abode-group.co.uk

Web: www.abode-group.co.uk

Web: www.abode-group.co.uk

Web: www.abode-group.co.uk