



12 Clifton Avenue

Halewood, Liverpool, L26 7ZJ

£360,000



Nestled on the sought-after Clifton Avenue in Halewood, this impressive four-bedroom detached property offers the perfect blend of space and convenience for modern family living. Boasting ample off-street parking for multiple vehicles, this home is as practical as it is welcoming. A spacious and well-maintained garden at the rear provides a fantastic outdoor retreat, ideal for family gatherings, gardening, or simply unwinding in the fresh air.

The ground floor features a generously sized kitchen, perfect for family meals and entertaining. Two separate lounges provide versatility, catering to both formal and informal living needs, while a convenient downstairs WC adds to the functionality of the home. Each space is thoughtfully laid out to enhance comfort and usability for busy households.

Upstairs, the property offers four well-proportioned bedrooms, making it an ideal choice for growing families. A centrally located family bathroom completes the upper level, ensuring convenience for all residents. Situated in a popular residential area with excellent local amenities, schools, and transport links, this home is a must-see for those seeking space and location in equal measure.



Area Map

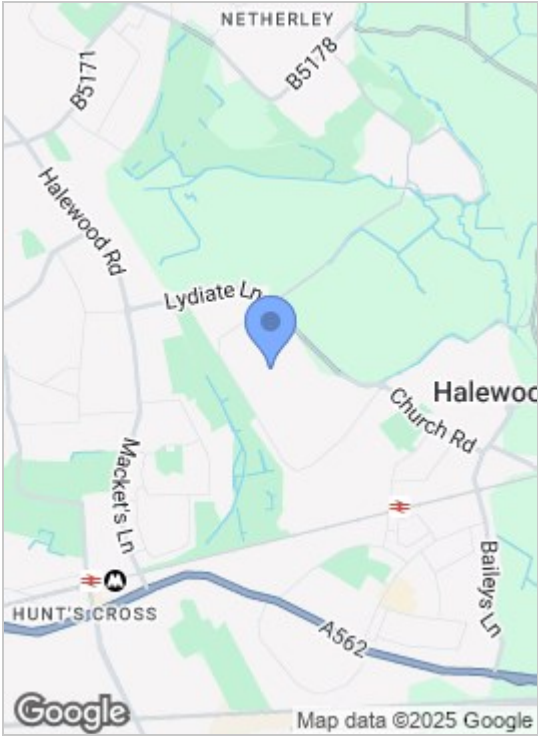

Floor Plans

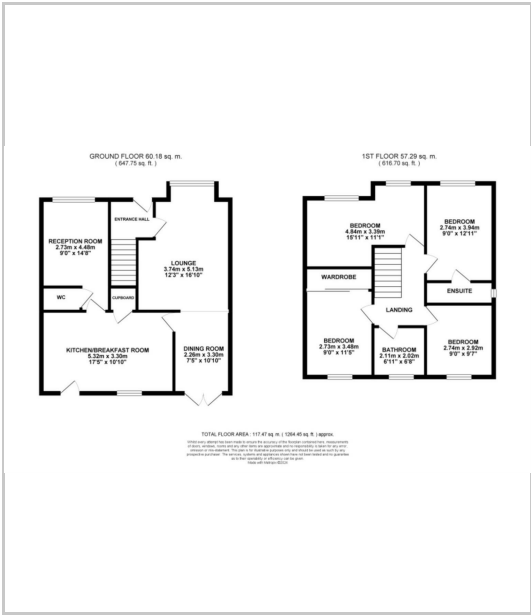

Energy Efficiency Graph

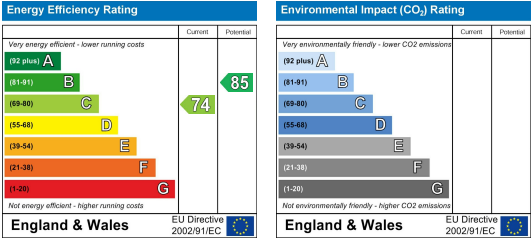

These particulars, whilst believed to be accurate are set out as a general outline only for guidance and do not constitute any part of an offer or contract. Intending purchasers should not rely on them as statements of representation of fact, but must satisfy themselves by inspection or otherwise as to their accuracy. No person in this firms employment has the authority to make or give any representation or warranty in respect of the property.