



## 12 Basil Close

Childwall, Liverpool, L16 5EL

**£260,000**



Situated in the charming Basil Close, Childwall, Liverpool, this superbly presented semi-detached house is an ideal family home. With three well-proportioned bedrooms, it offers ample space for both relaxation and privacy. The property boasts two inviting reception rooms, perfect for entertaining guests or enjoying quiet family evenings.

One of the standout features of this home is the extended open plan kitchen and dining room, which creates a warm and welcoming atmosphere. This modern space is designed for both functionality and style, making it a delightful area for family meals and gatherings. Additionally, the utility room provides extra convenience, ensuring that household chores are easily managed.

The property also benefits from a secluded rear garden, offering a peaceful retreat for outdoor activities or simply unwinding in the fresh air. This private space is perfect for children to play or for hosting summer barbecues with friends and family.

Overall, this extended family home on Basil Close is a wonderful opportunity for those seeking a blend of comfort, style, and practicality in a desirable Liverpool location. Don't miss the chance to make this lovely property your own.





Area Map

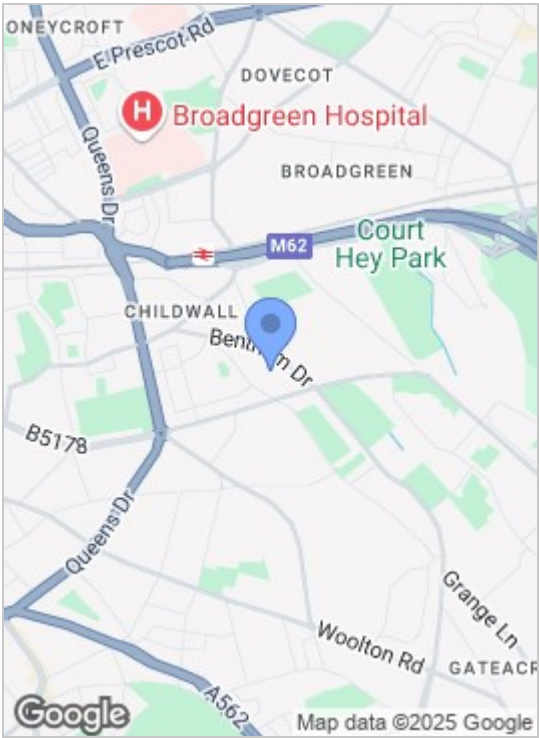

Floor Plans

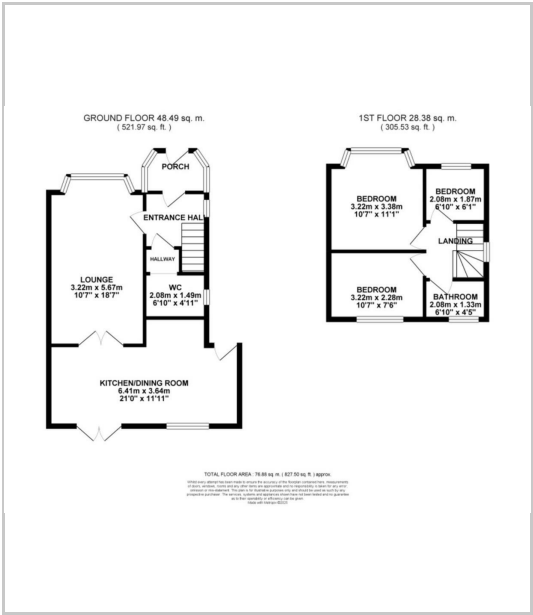

Energy Efficiency Graph

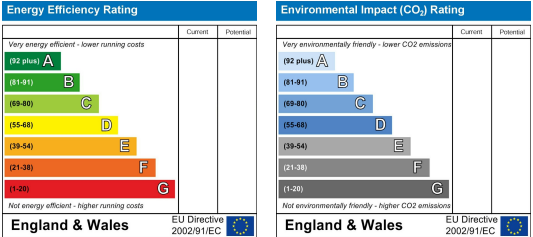

These particulars, whilst believed to be accurate are set out as a general outline only for guidance and do not constitute any part of an offer or contract. Intending purchasers should not rely on them as statements of representation of fact, but must satisfy themselves by inspection or otherwise as to their accuracy. No person in this firms employment has the authority to make or give any representation or warranty in respect of the property.

82 Coronation Road, Crosby, Liverpool L23 5RH

**Tel:** 0151 909 3003  
**Email:** crosby@abode-group.co.uk  
**Web:** www.abode-group.co.uk

6 Allerton Road, Mossley Hill, Liverpool, L18 1LN

**Tel:** 0151 601 3003  
**Email:** allerton@abode-group.co.uk  
**Web:** www.abode-group.co.uk

2 Chapel Lane, Formby, Liverpool, L37 4DU

**Tel:** 01704 827 402  
**Email:** formby@abode-group.co.uk  
**Web:** www.abode-group.co.uk