



1 Karslake Road

Mossley Hill, Liverpool, L18 1EY

Offers over £350,000



Situated in the desirable area of Mossley Hill, Liverpool, this superbly presented end terrace house on Karslake Road offers an exceptional family living experience. With five spacious bedrooms, this property provides ample room for both relaxation and privacy. The layout includes two inviting reception rooms, perfect for entertaining guests or enjoying quiet family time.

The heart of the home is undoubtedly the open plan kitchen and dining room, which creates a warm and welcoming atmosphere for family gatherings and dinner parties. The kitchen is well-equipped, making it a joy for any home cook. Additionally, the property features a convenient utility room and a downstairs shower room, enhancing the practicality of daily living.

With three well-appointed bathrooms, morning routines will be a breeze, ensuring that everyone has their own space. The house is located in close proximity to Sefton Park, offering beautiful green spaces for leisurely walks and outdoor activities.

Families will appreciate the excellent local schools in the area, making this property an ideal choice for those with children. This home combines comfort, style, and convenience, making it a perfect opportunity for anyone looking to settle in a vibrant community. Don't miss the chance to make this delightful property your new home.



Area Map

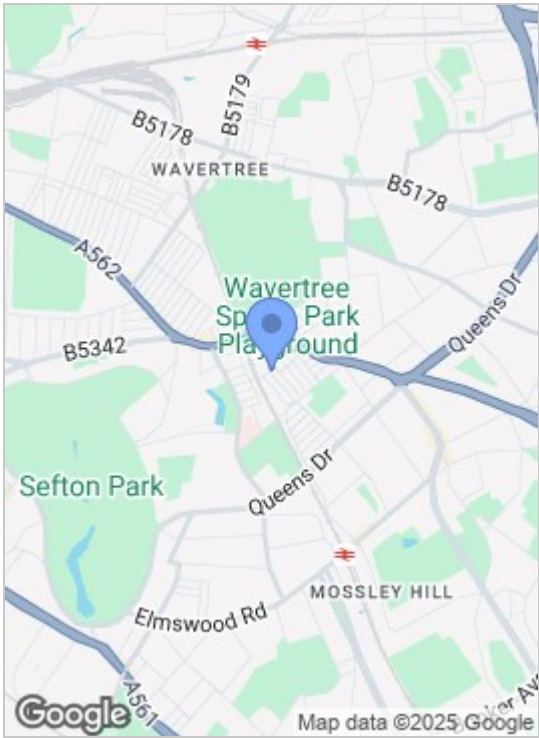

Floor Plans

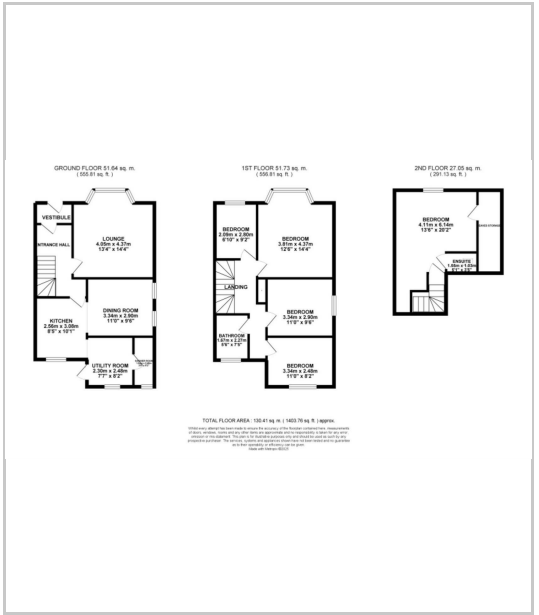

Energy Efficiency Graph

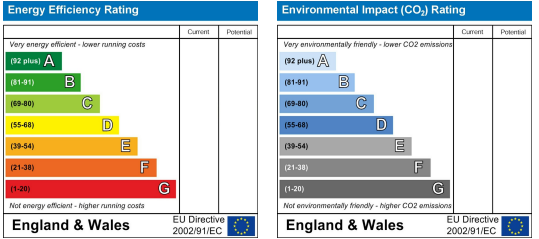

These particulars, whilst believed to be accurate are set out as a general outline only for guidance and do not constitute any part of an offer or contract. Intending purchasers should not rely on them as statements of representation of fact, but must satisfy themselves by inspection or otherwise as to their accuracy. No person in this firms employment has the authority to make or give any representation or warranty in respect of the property.