



# 113 Vandyke Street

Toxteth, Liverpool, L8 0RS

**Offers over £210,000**



Nestled on the charming Vandyke Street in Toxteth, Liverpool, this superbly presented semi-detached house offers an ideal family home. With four spacious bedrooms, this property provides ample room for both relaxation and entertainment. The two inviting reception rooms are perfect for hosting guests or enjoying quiet evenings with family.

The heart of the home is undoubtedly the open plan kitchen and dining area, which creates a warm and welcoming atmosphere for gatherings. This modern space is designed for both functionality and style, making it a delightful place to prepare meals and share moments with loved ones.

Step outside to discover a beautifully presented and secluded rear courtyard, an oasis of tranquillity where you can unwind after a busy day. This outdoor space is perfect for al fresco dining or simply enjoying the fresh air in a private setting.

Location is key, and this property does not disappoint. It is within walking distance to the picturesque Sefton Park, offering a perfect escape for leisurely strolls or family picnics. Additionally, the city centre is just a short





Area Map

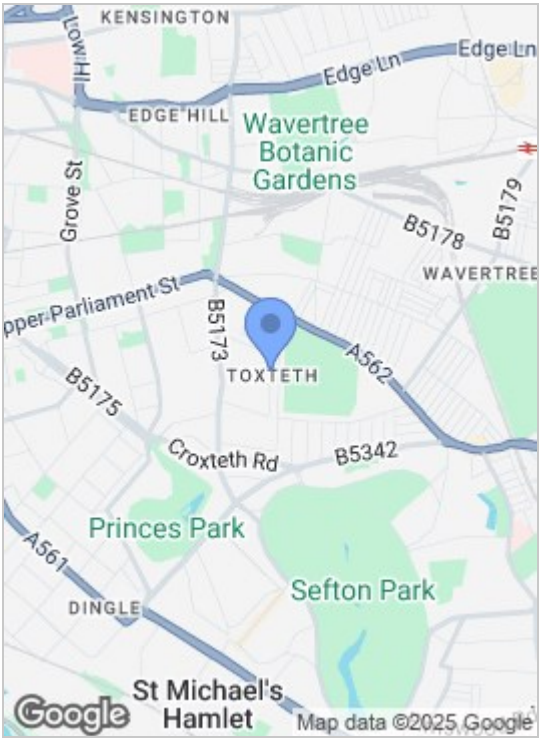

Floor Plans

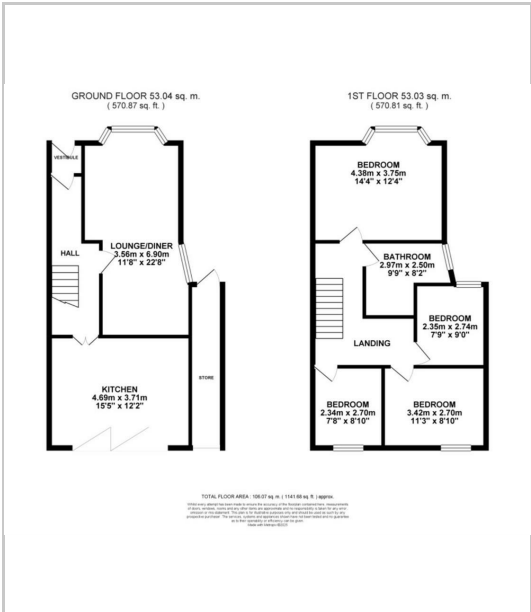

Energy Efficiency Graph

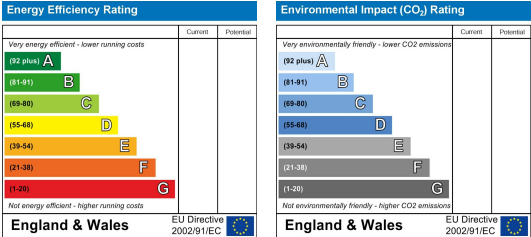

These particulars, whilst believed to be accurate are set out as a general outline only for guidance and do not constitute any part of an offer or contract. Intending purchasers should not rely on them as statements of representation of fact, but must satisfy themselves by inspection or otherwise as to their accuracy. No person in this firms employment has the authority to make or give any representation or warranty in respect of the property.

82 Coronation Road, Crosby, Liverpool L23 5RH

Tel: 0151 909 3003  
Email: crosby@abode-group.co.uk  
Web: www.abode-group.co.uk

6 Allerton Road, Mossley Hill, Liverpool, L18 1LN

Tel: 0151 601 3003  
Email: allerton@abode-group.co.uk  
Web: www.abode-group.co.uk

2 Chapel Lane, Formby, Liverpool, L37 4DU

Tel: 01704 827 402  
Email: formby@abode-group.co.uk  
Web: www.abode-group.co.uk