



329 Thingwall Road

Wavertree, Liverpool, L15 7LD

Offers over £285,000



****WATCH OUR VIDEO TO WHET YOUR APPETITE****

Are you looking for something to put your own stamp on? Abode are delighted to offer for sale this three bedroom characterful family home situated in a prestigious Wavertree Garden Suburb location. With a range of amenities in close proximity such as shops, supermarkets, excellent transport links and a number of top quality schools in the area, Thingwall Road has everything to offer the potential buyer.

The property itself briefly comprises an entrance hall, storage cupboard, spacious lounge, dining room and fitted kitchen all to the ground floor. To the first floor there are three good sized bedrooms and shower room.

Outside there is a beautifully landscaped and secluded rear garden and to the front there is another well presented garden with the potential for off road parking. CALL NOW FOR AN EARLY VIEWING.

No Chain.



Area Map

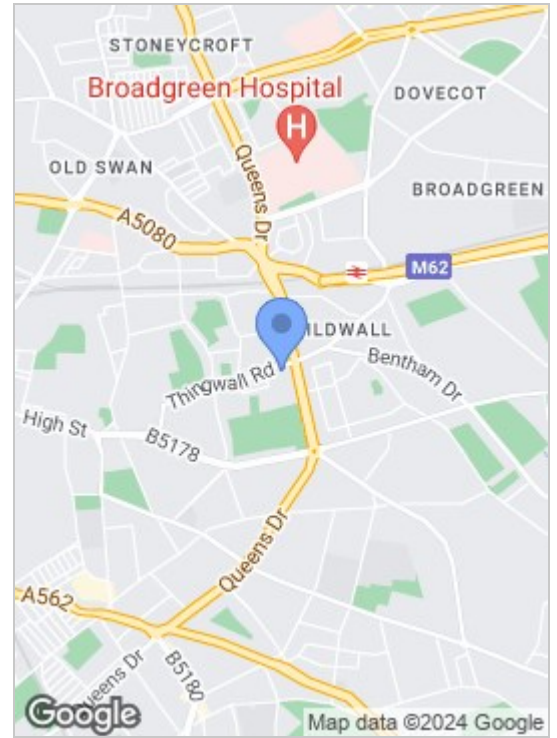

Floor Plans

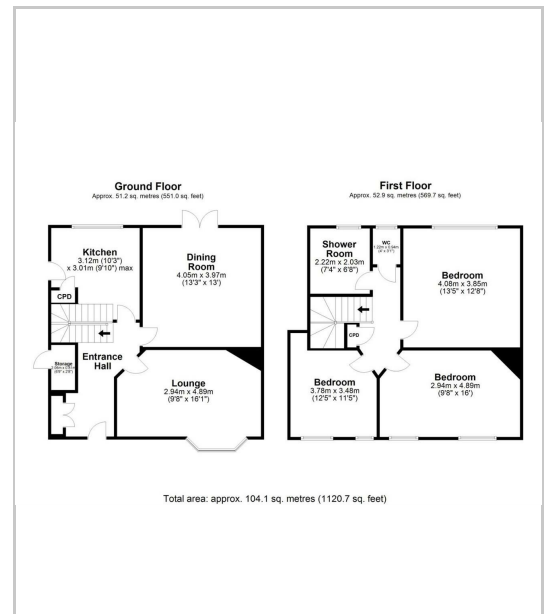

Energy Efficiency Graph

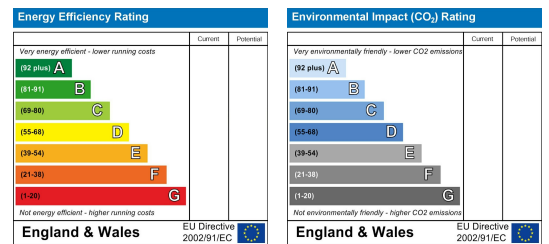

These particulars, whilst believed to be accurate are set out as a general outline only for guidance and do not constitute any part of an offer or contract. Intending purchasers should not rely on them as statements of representation of fact, but must satisfy themselves by inspection or otherwise as to their accuracy. No person in this firm's employment has the authority to make or give any representation or warranty in respect of the property.

82 Coronation Road, Crosby, Liverpool L23 5RH

6 Allerton Road, Mossley Hill, Liverpool, L18 1LN

2 Chapel Lane, Formby, Liverpool, L37 4DU

Tel: 0151 909 3003

Email: crosby@abode.group.co.uk

Web: www.abode-group.co.uk

Tel: 0151 601 3003

Email: allerton@abode-group.co.uk

Web: www.abode-group.co.uk

Tel: 01704 827 402

Email: formby@abode-group.co.uk

Web: www.abode-group.co.uk