



Boothroyd House, Draymans Way – TW7

£260,000 Leasehold

This well presented and spacious one-bedroom top-floor apartment is situated in the ever popular Maltings development. The property offers a large double bedroom with built in wardrobe, modern bathroom, separate kitchen and a good sized reception room with bay window. The property has been well maintained throughout and benefits from access to loft space, ample internal storage and allocated parking. The property is ideally located close to local schools, transport links and amenities, plus the Thames riverside.

OAKHILL



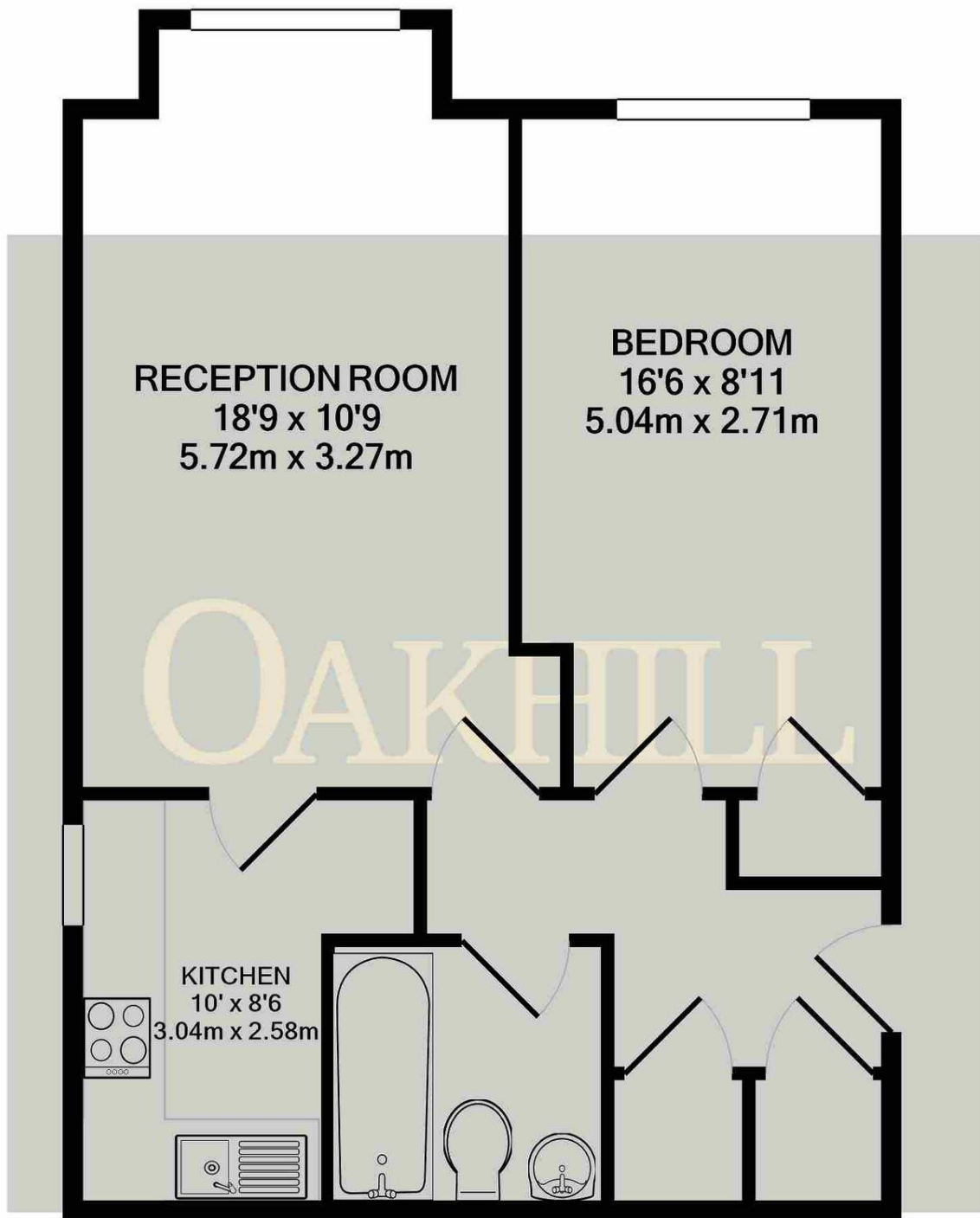

Whilst every attempt has been made to ensure the accuracy of the floor plan contained here, measurements of doors, windows, rooms and any other items are approximate and no responsibility is taken for any error, omission, or mis-statement. This plan is for illustrative purposes only and should be used as such by any prospective purchaser. The services, systems and appliances shown have not been tested and no guarantee as to their operability or efficiency can be given
Made with Metropix ©2024



Oakhill Estate Agents

6 South Street, Isleworth, TW7 7BG

OAKHILL