

Malting Way – TW7

£290,000 Leasehold

Situated in the ever popular Maltings development, just a short walk from Isleworth train station and the shops, cafes and bars of Isleworth Village, this well presented two double bedroom, ground floor apartment is offered to the market with no forward chain. The property offers a welcoming hallway, master bedroom with built in wardrobes, second double bedroom, family bathroom, spacious reception room with a bay window and separate kitchen. The property also benefits from allocated parking, gas central heating and well kept communal areas.

OAKHILL



646 sq.ft. (60.0 sq.m.) approx.

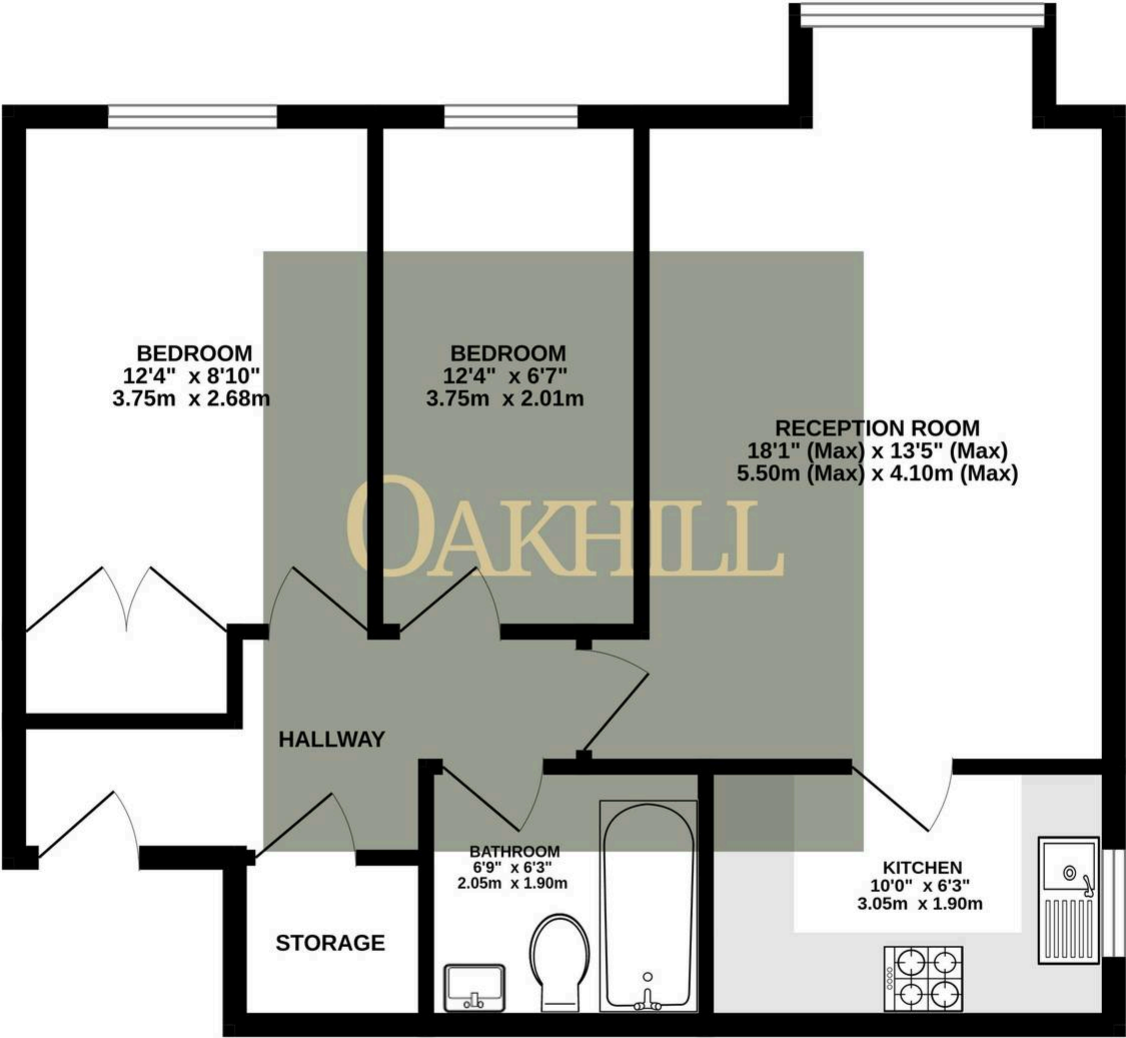

TOTAL FLOOR AREA : 646 sq.ft. (60.0 sq.m.) approx.

Whilst every attempt has been made to ensure the accuracy of the floorplan contained here, measurements of doors, windows, rooms and any other items are approximate and no responsibility is taken for any error, omission or mis-statement. This plan is for illustrative purposes only and should be used as such by any prospective purchaser. The services, systems and appliances shown have not been tested and no guarantee as to their operability or efficiency can be given.
Made with Metropix ©2025



Oakhill Estate Agents
6 South Street, TW7 7BG

