



Woodland Gardens, Isleworth – TW7 6LW

£750,000 Freehold

Beautifully presented four bedroom semi detached family home situated on the inner circle of Woodland Gardens backing onto the WERFA Pavilion. Offering driveway parking and rear access to the double garage, this property really does tick all the boxes. The ground floor accommodation features a spacious reception room, large open plan modern kitchen/dining room with direct access to the rear garden, under stairs storage. The first floor offers a modern family bathroom, two large double bedrooms and a further single bedroom. The loft has been converted to provide a stunning master bedroom with en-suite shower room. Woodland Gardens is ideally situated within a short walk of Isleworth station, a choice of schools and the shops and amenities of St. Johns Road and London Road.

OAKHILL



GROUND FLOOR

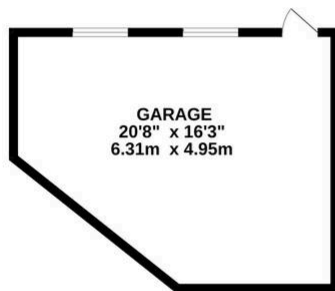
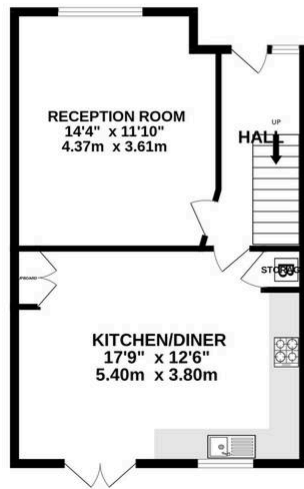

1ST FLOOR

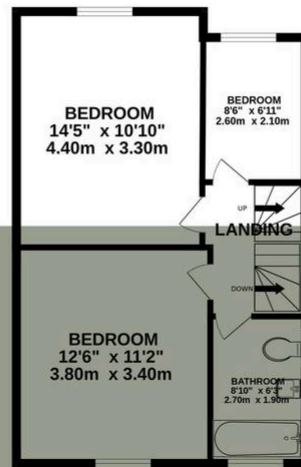

2ND FLOOR



OAKHILL

Whilst every attempt has been made to ensure the accuracy of the floorplan contained here, measurements of doors, windows, rooms and any other items are approximate and no responsibility is taken for any error, omission or mis-statement. This plan is for illustrative purposes only and should be used as such by any prospective purchaser. The services, systems and appliances shown have not been tested and no guarantee as to their operability or efficiency can be given.
Made with Metropix 5/2025

OAKHILL

