



Hepple Close, Isleworth - TW7

£250,000 Leasehold

Situated in a quiet, gated development, within a short walk of Syon Lane train station, Syon park and local amenities, this first floor one bedroom flat is offered to the market with no forward chain. The property offers a spacious double bedroom with built in wardrobe, large reception room, sperate kitchen and modern bathroom. The property also benefits from allocated parking, a long lease and ample internal storage.

OAKHILL



GROUND FLOOR

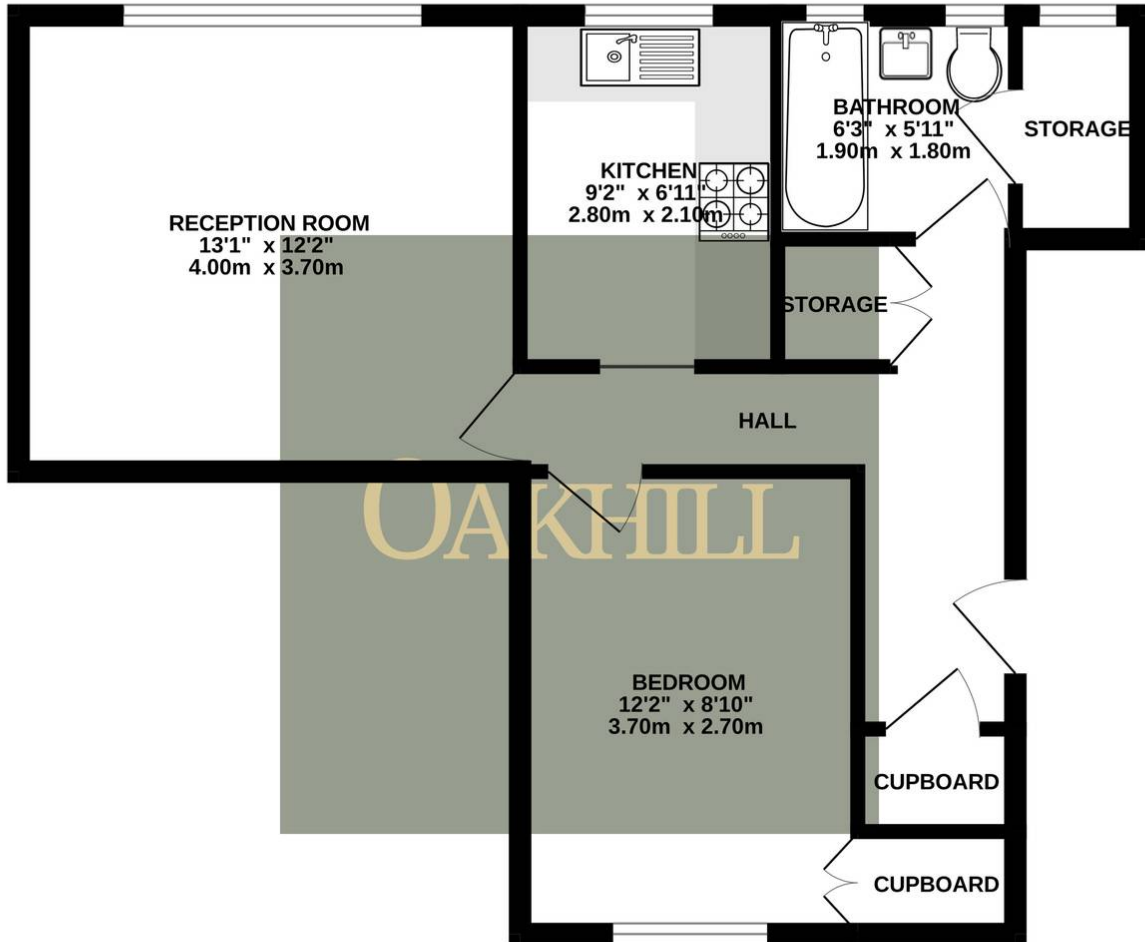

Whilst every attempt has been made to ensure the accuracy of the floorplan contained here, measurements of doors, windows, rooms and any other items are approximate and no responsibility is taken for any error, omission or mis-statement. This plan is for illustrative purposes only and should be used as such by any prospective purchaser. The services, systems and appliances shown have not been tested and no guarantee as to their operability or efficiency can be given.
Made with Metropix ©2024

OAKHILL

Oakhill Estate Agents

6 South Street, TW7 7GB

OAKHILL