



Milestone Court, London Road, Isleworth – TW7

£275,000 Leasehold

Situated in a popular gated development, this well presented one bedroom ground floor apartment is offered to the market with no forward chain. Situated within walking distance of Syon Lane train station, local amenities and Syon Park the property offers a welcoming hallway, large double bedroom with built in wardrobes, bathroom, separate kitchen and spacious reception room. The property also benefits from double glazing and gated allocated parking.

OAKHILL



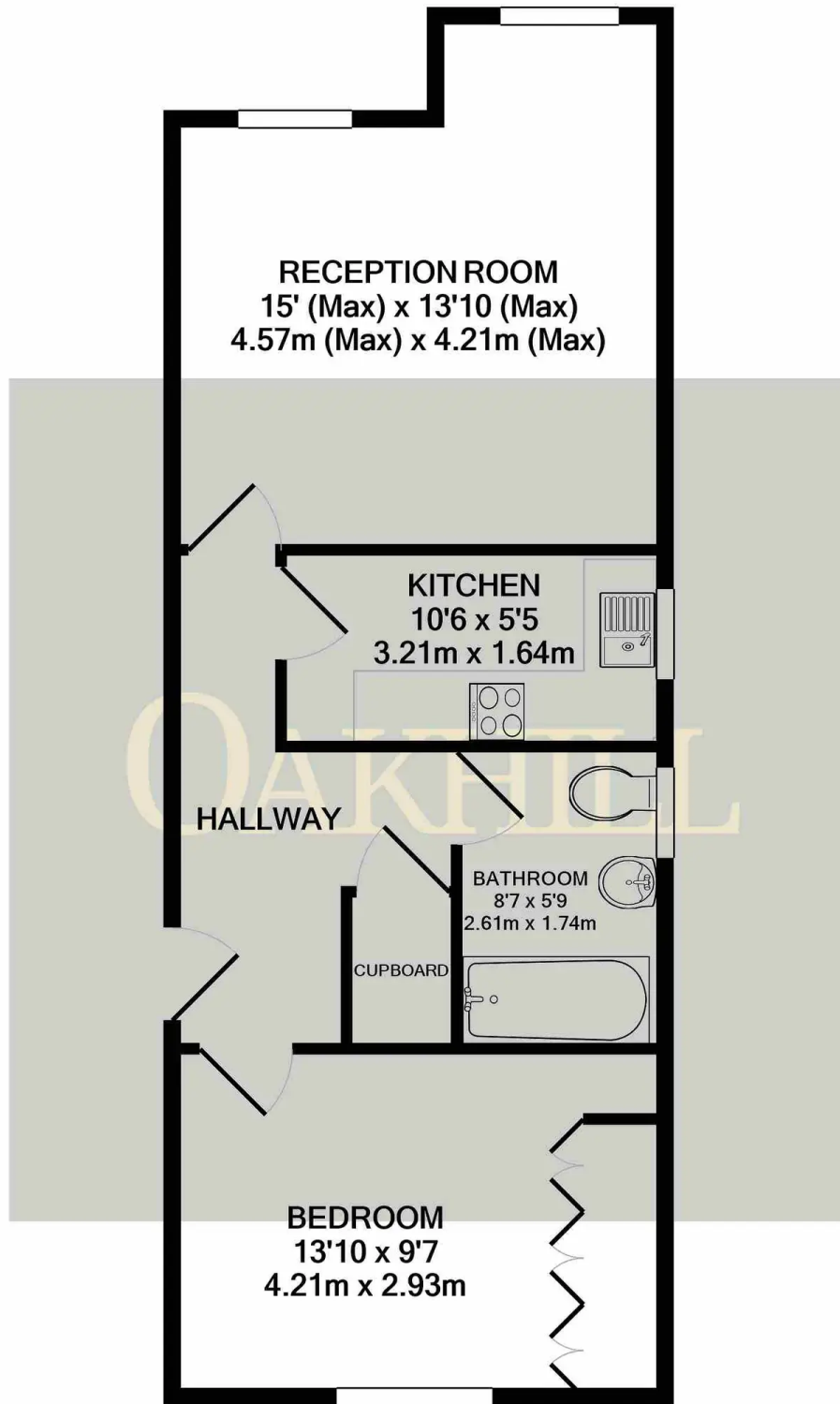

Whilst every attempt has been made to ensure the accuracy of the floor plan contained here, measurements of doors, windows, rooms and any other items are approximate and no responsibility is taken for any error, omission, or mis-statement. This plan is for illustrative purposes only and should be used as such by any prospective purchaser. The services, systems and appliances shown have not been tested and no guarantee as to their operability or efficiency can be given
Made with Metropix ©2024



Oakhill Estate Agents

6 South Street, Isleworth, TW7 7BG

