



## Cambridge Road, Hounslow – TW4

£230,000 Leasehold

This spacious, top floor one bedroom flat is offered to the market with no forward chain. Situated on a prime residential road close to public transport and local amenities, the property is well presented throughout. Offering its own private entranceway, spacious double bedroom with built in wardrobe, large reception room, modern kitchen/diner, family bathroom and utility area, the property also benefits from a long lease, gas central heating and double glazing throughout the property. Parking is readily available on the street on a first come first serve basis.

OAKHILL





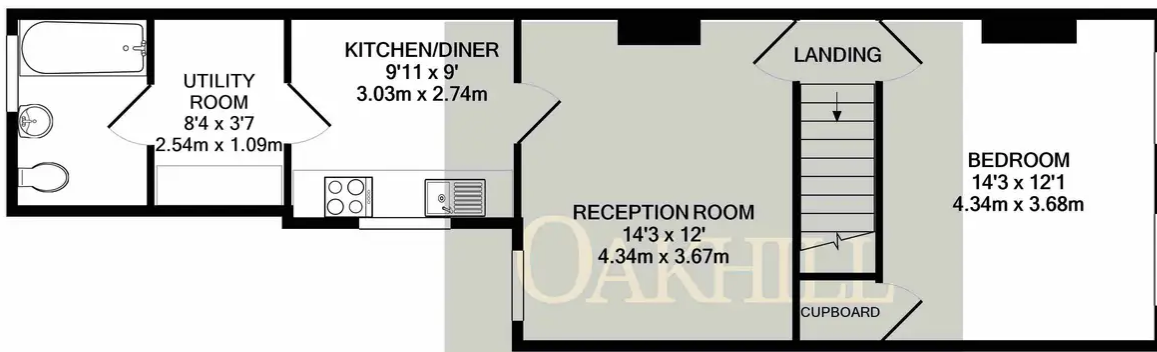

1ST FLOOR

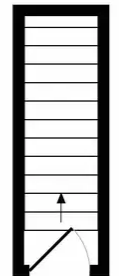

GROUND FLOOR

Whilst every attempt has been made to ensure the accuracy of the floor plan contained here, measurements of doors, windows, rooms and any other items are approximate and no responsibility is taken for any error, omission, or mis-statement. This plan is for illustrative purposes only and should be used as such by any prospective purchaser. The services, systems and appliances shown have not been tested and no guarantee as to their operability or efficiency can be given  
 Made with Metropix ©2024

OAKHILL

Oakhill Estate Agents

6 South Street, Isleworth, TW7 7BG

