



Warkworth Gardens, Isleworth – TW7

£415,000 Leasehold

Having been fully refurbished throughout, this beautifully presented three bedroom first floor maisonette is offered to the market with no forward chain. Located in a quiet cul-de-sac, moments from Syon Lane station, local schools and amenities, the property offers two good sized double bedrooms, single bedroom, a bright and spacious reception room, modern kitchen and luxury family bathroom. Externally the property offers a large private rear garden. The property also benefits from a long lease in excess of 900 years, access to loft space, gas central heating and double glazing throughout. Resident permit parking is available.

OAKHILL



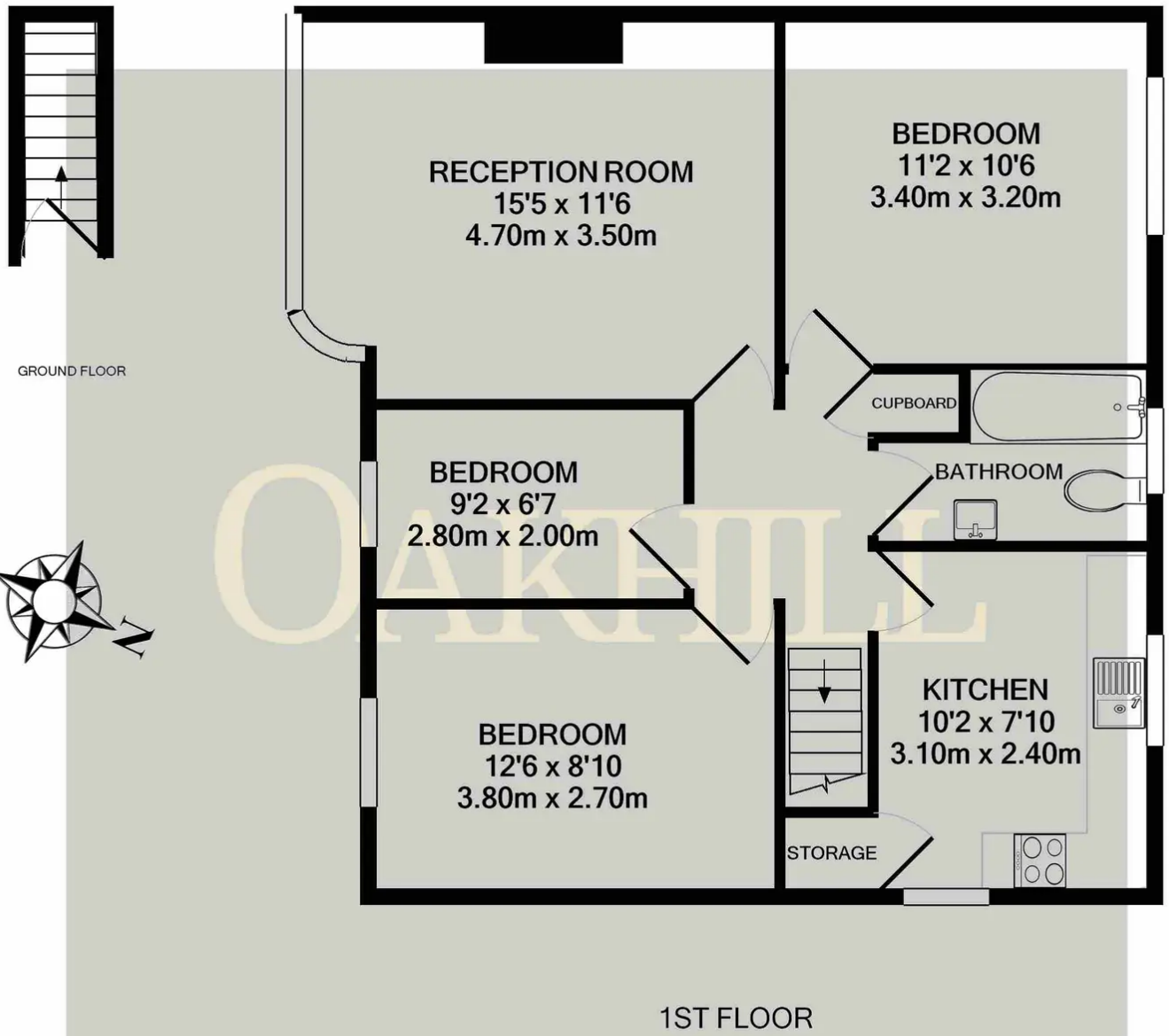

Whilst every attempt has been made to ensure the accuracy of the floor plan contained here, measurements of doors, windows, rooms and any other items are approximate and no responsibility is taken for any error, omission, or mis-statement. This plan is for illustrative purposes only and should be used as such by any prospective purchaser. The services, systems and appliances shown have not been tested and no guarantee as to their operability or efficiency can be given
 Made with Metropix ©2024



Oakhill Estate Agents

6 South Street, Isleworth, TW7 7BG

