



John Busch House, London Road – TW7

£325,000 Leasehold

This beautifully presented modern apartment with secure allocated parking is located on the first floor of this popular development. Situated within a short walk of Syon Lane station, Syon Park and Old Isleworth riverside, this would make the ideal first time or investment purchase. The accommodation comprises a superb open plan reception with modern kitchen inclusive of built in appliances, spacious double bedroom with built in wardrobes, modern bathroom and a large storage cupboard in the hallway. Further features include well kept communal areas and and lift access.

OAKHILL



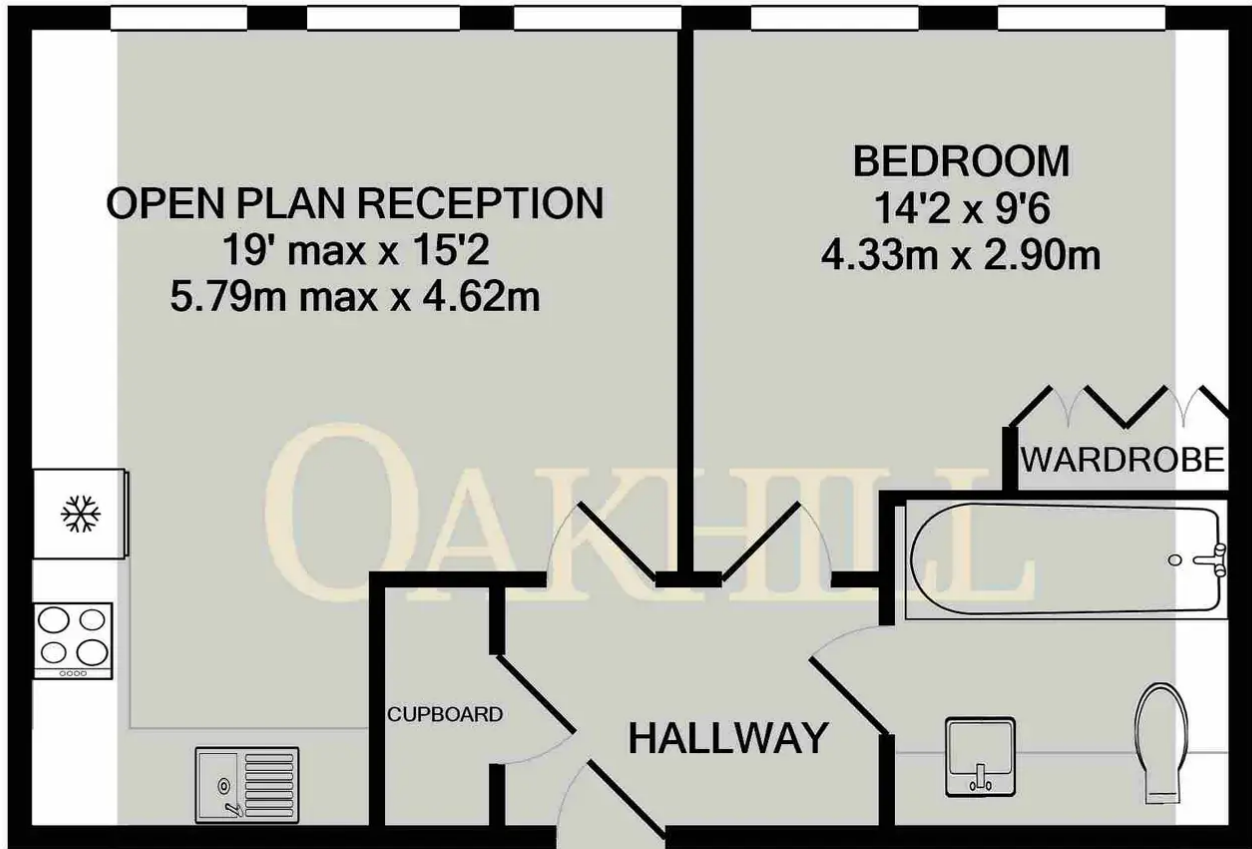

Whilst every attempt has been made to ensure the accuracy of the floor plan contained here, measurements of doors, windows, rooms and any other items are approximate and no responsibility is taken for any error, omission, or mis-statement. This plan is for illustrative purposes only and should be used as such by any prospective purchaser. The services, systems and appliances shown have not been tested and no guarantee as to their operability or efficiency can be given
Made with Metropix ©2024



Oakhill Estate Agents

6 South Street, Isleworth, TW7 7BG

