



## Flat 37, Lancaster House Borough Road, Isleworth – TW7 5FJ

£420,000 Leasehold

Forming part of a beautiful Grade II listed period building on a popular residential road close to both Isleworth train station and Osterley tube station, this stunning two bedroom first floor apartment is offered to the market.

Beautifully presented throughout, the property features a welcoming hallway, spacious reception room with an open plan, modern fitted kitchen, luxury family bathroom, master bedroom with fitted wardrobes and a second double bedroom. With secure gated access to the development, the property also benefits from allocated parking, well kept communal areas, double glazing and gas central heating.

OAKHILL





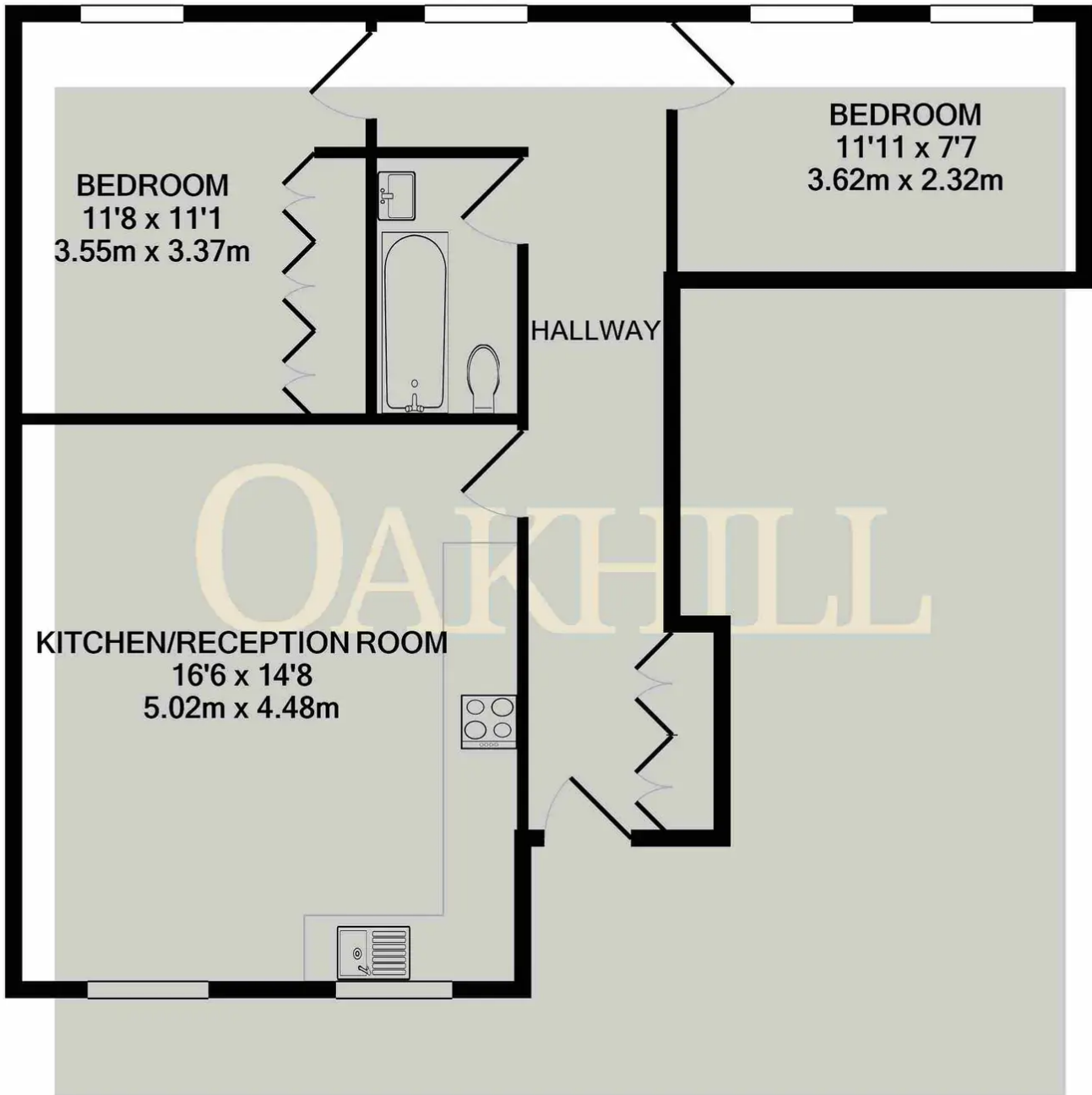

Whilst every attempt has been made to ensure the accuracy of the floor plan contained here, measurements of doors, windows, rooms and any other items are approximate and no responsibility is taken for any error, omission, or mis-statement. This plan is for illustrative purposes only and should be used as such by any prospective purchaser. The services, systems and appliances shown have not been tested and no guarantee as to their operability or efficiency can be given  
Made with Metropix ©2024



Oakhill Estate Agents

6 South Street, Isleworth, TW7 7BG

OAKHILL