



## Taylor Close, Hounslow – TW3 4BZ

£230,000 Leasehold

This well presented one bedroom ground floor flat is offered to the market with no forward chain. Situated in a quiet cul-de-sac close to Isleworth Train Station, Osterley Tube Station, local schools and amenities, this property is perfect for both investors and first-time buyers. Offering a spacious reception room, separate kitchen, double bedroom with built in wardrobe and family bathroom. The property also benefits from allocated parking, double glazing, internal storage and access to a communal garden.

OAKHILL



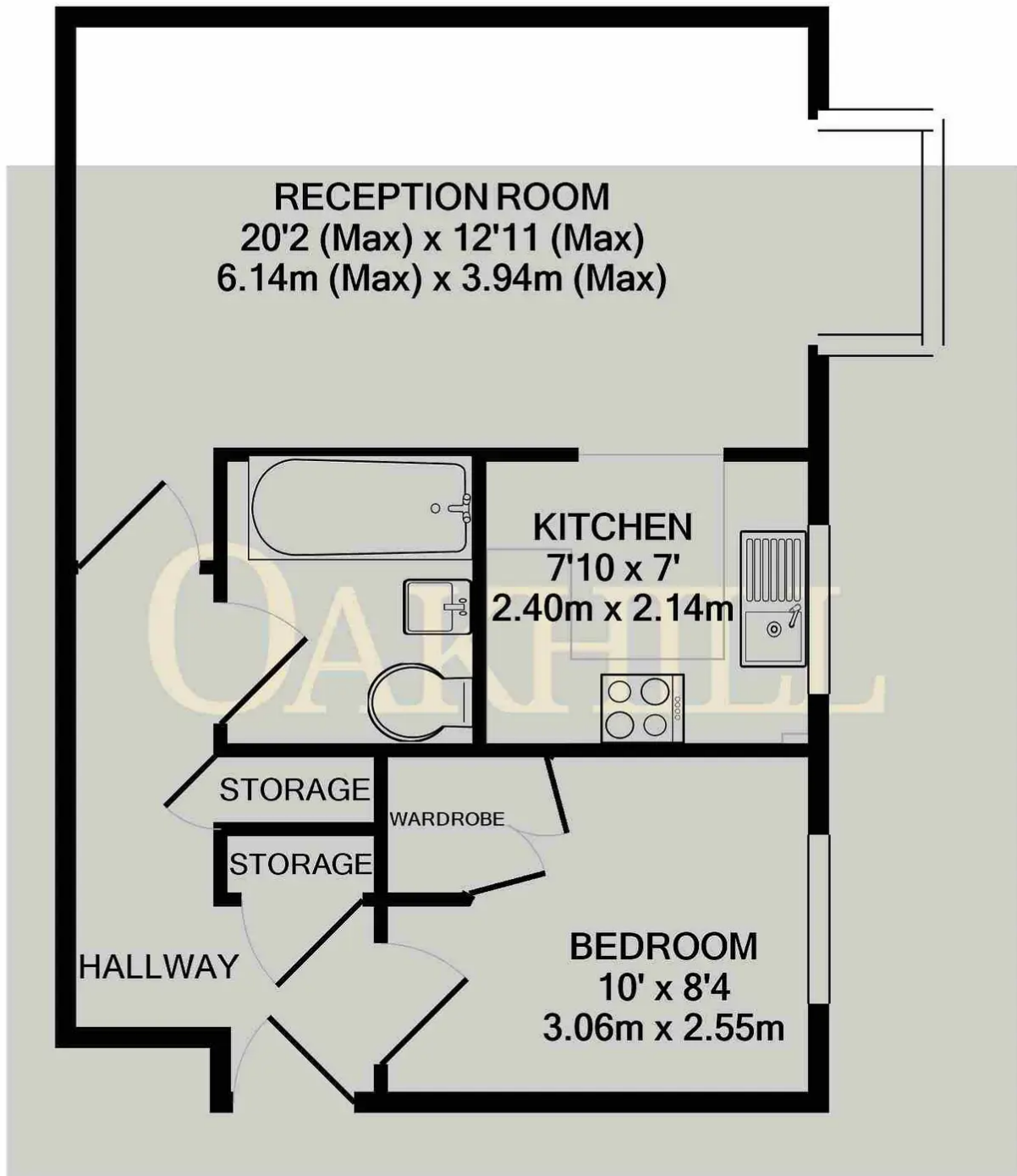

Whilst every attempt has been made to ensure the accuracy of the floor plan contained here, measurements of doors, windows, rooms and any other items are approximate and no responsibility is taken for any error, omission, or mis-statement. This plan is for illustrative purposes only and should be used as such by any prospective purchaser. The services, systems and appliances shown have not been tested and no guarantee as to their operability or efficiency can be given

Made with Metropix ©2024



Oakhill Estate Agents

6 South Street, Isleworth, TW7 7BG

