

L·D·B

SALES, LETTINGS
& MANAGEMENT



4 KYNANCE MEWS, SOUTH KENSINGTON, LONDON, SW7 4QP

NESTLED IN THE CHARMING KYNANCE MEWS OF SOUTH KENSINGTON, THIS DELIGHTFUL HOUSE OFFERS A PERFECT BLEND OF COMFORT AND STYLE. SPANNING AN IMPRESSIVE 1,000 SQUARE FEET, THE PROPERTY FEATURES THREE WELL-APPOINTED BEDROOMS, MAKING IT AN IDEAL HOME FOR FAMILIES OR PROFESSIONALS SEEKING AMPLE SPACE.

THE SEMI-OPEN PLAN KITCHEN, LIVING, AND DINING AREA ON THE FIRST FLOOR IS PARTICULARLY NOTEWORTHY, OFFERING A SPACIOUS LAYOUT THAT IS PERFECT FOR BOTH ENTERTAINING GUESTS AND ENJOYING QUIET FAMILY MEALS. THE DESIGN ALLOWS FOR A SEAMLESS FLOW BETWEEN THE KITCHEN AND LIVING SPACES, ENHANCING THE OVERALL SENSE OF OPENNESS.

THE PROPERTY BOASTS TWO MODERN BATHROOMS, ENSURING CONVENIENCE FOR ALL RESIDENTS. EACH BEDROOM IS THOUGHTFULLY DESIGNED TO PROVIDE A PEACEFUL RETREAT, WITH PLENTY OF NATURAL LIGHT AND STORAGE OPTIONS.

KYNANCE MEWS IS RENOWNED FOR ITS FANTASTIC LOCATION, PROVIDING EASY ACCESS TO A WEALTH OF LOCAL AMENITIES, INCLUDING SHOPS, RESTAURANTS, AND EXCELLENT TRANSPORT LINKS.

- FANTASTIC LOCATION
- TWO EN SUITE BATHROOMS
- RECENTLY REDECORATED THROUGHOUT
- UNIQUELY DESIGNED MEWS HOUSE
- BRIGHT AND SPACIOUS LIVING ROOM

£5,250 PCM

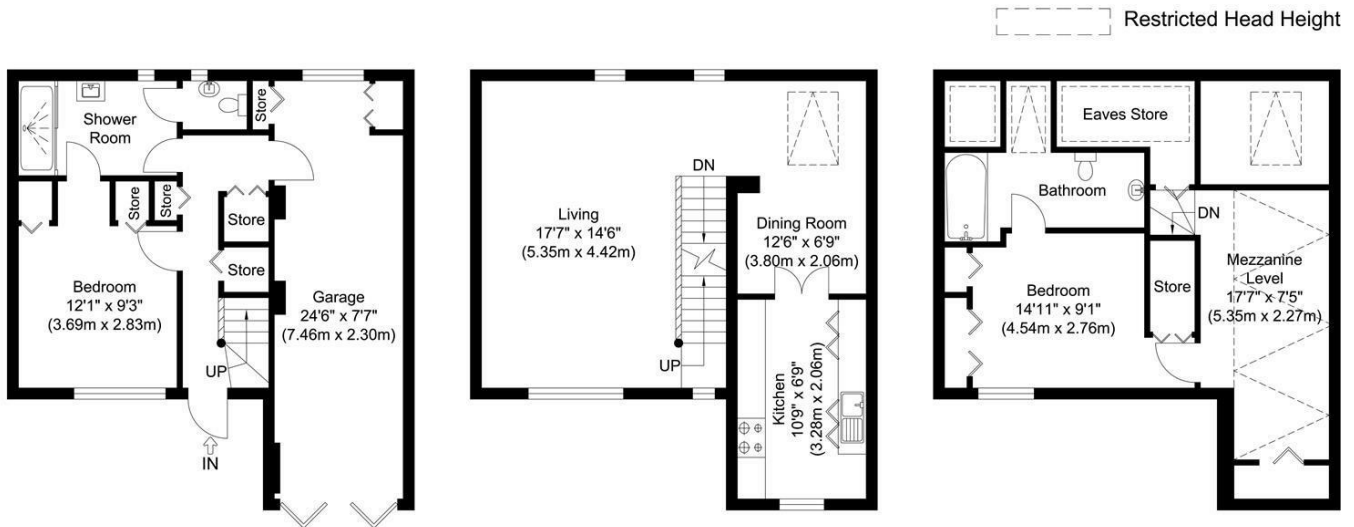

Ground Floor
Approximate Floor Area
454.23 sq. ft.
(42.20 sq. m)



First Floor
Approximate Floor Area
454.23 sq. ft.
(42.20 sq. m)

Top Floor
Approximate Floor Area
441.42 sq. ft.
(41.01 sq. m)

Total Gross Internal Area
1349.90 sq. ft.
(125.41 sq. m)

Kynance Mews, London, SW7

Illustration for identification purposes only, measurements are approximate, not to scale.

