



22 Radcliffe Road, Moorside, Oldham

£145,000

🛏️ 2 🚿 1 🚪 1



- Mid Terrace
- Two Bedrooms
- Two Reception Rooms
- Newly Decorated Throughout
- Ideal FTB or Young Family
- Popular Location
- EPC - C



Offered for sale with NO CHAIN therefore VACANT POSSESSION is this two bedroom two reception room mid terraced property. Ideally suited to either first time buyers, young families or buy to let investors wanting to expand their portfolio. Located just off Ripponden Road therefore close to local amenities, schools and transport links. The property has just been decorated throughout and internally comprises of, to the ground floor entrance vestibule, hallway, lounge, separate dining room and kitchen whilst to the first floor there are two bedrooms and a family bathroom. Externally there is a low maintenance forecourt and to the rear an enclosed garden with artificial grass and patio area plus, a useful store. The property also benefits from double glazing and gas central heating.

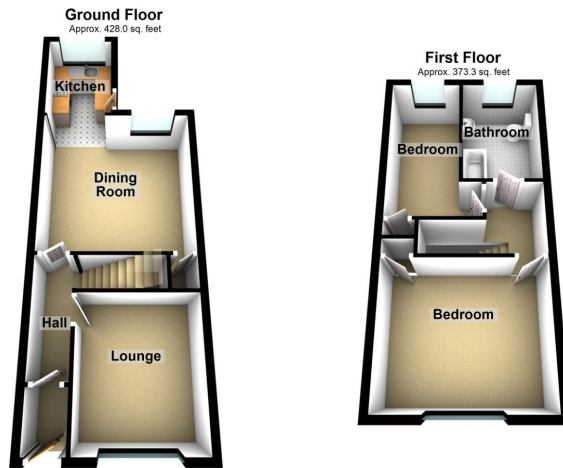

Total area: approx. 801.3 sq. feet

Score	Energy rating	Current	Potential
92+	A		
81-91	B		86 B
69-80	C	70 C	
55-68	D		
39-54	E		
21-38	F		
1-20	G		

Chadderton Office

509 Middleton Road,
Chadderton, Oldham,
OL9 9SH

chadderton@kirkham-property.co.uk
t: 0161 626 5688