



6 Woolmore Avenue,
£220,000

3 1 1



- No Chain
- Semi Detached
- Three Bedrooms
- Good Size Kitchen/Dining Room
- Brand New Carpets
- Good Condition Throughout
- Well Appointed South Facing Rear Garden
- EPC:



NO CHAIN.

Offered for sale is this three bedroom semi detached family home located close to both Royton and Oldham.

Accommodation comprising: Entrance hallway, WC, lounge and a kitchen/dining room.

To the first floor there are three bedrooms and a bathroom.

Externally there is a good size south east facing rear garden with a good amount to the side.

To the front is a lawn area and driveway parking for two cars.

Get yourself an appointment to view, it just might become your new home !

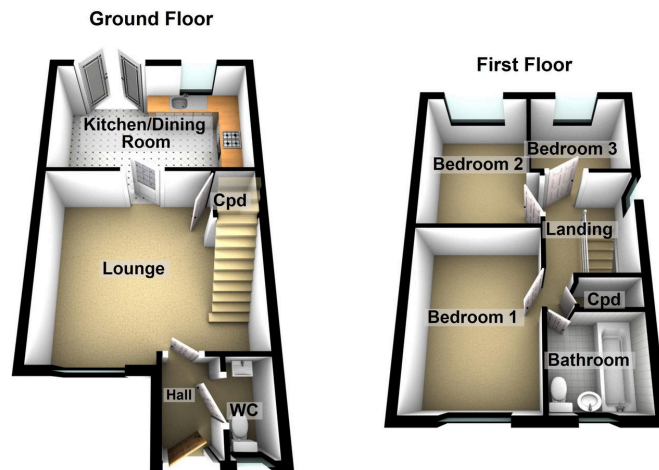

Chadderton Office

509 Middleton Road,
Chadderton, Oldham,
OL9 9SH

chadderton@kirkham-property.co.uk
t: 0161 626 5688