



3 Kingfisher Hollow, Chadderton Fold, Oldham, OL1 2RR

£575,000

🛏 3 🚿 2 🛋 1



- NEW BUILD - Detached Bungalow
- Open Plan Living
- Specification Upgrades Available - P.O.A.
- Countryside Aspect
- Three Double Bedrooms
- Two Bathrooms (inc En-suite to Master Bedroom)
- Secluded Location
- EPC - Aiming for A Rating

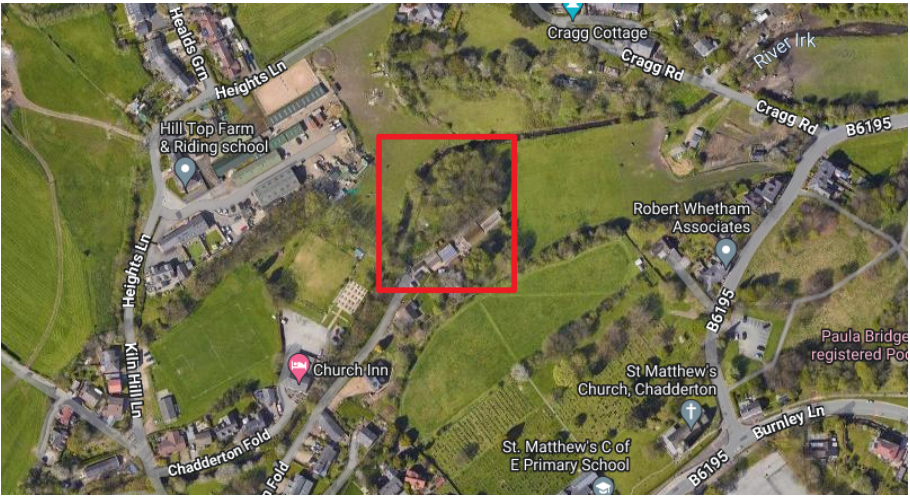
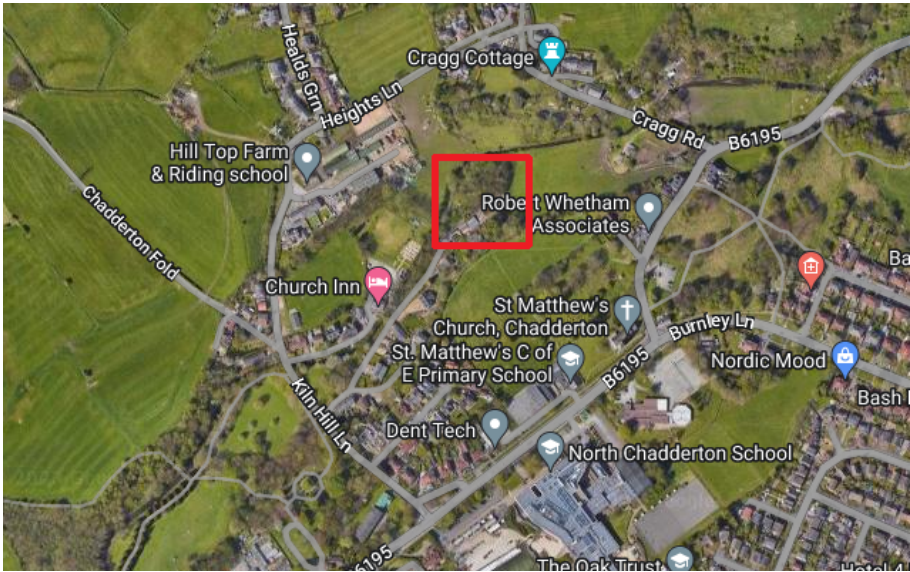

LAST ONE REMAINING - have you ever dreamt of living in a bespoke, unique and new build, three double bedroom detached bungalow, nestled in a countryside location occupying the enviable corner plot with an open outlook and substantial gardens extending down to the river Irk. This sought-after, prestige development of three bungalows constructed by Stonerand (local builders to the area for over 50 years) is at the end of Chadderton Fold on the site of the former Cattery. At this stage offering a degree of customisation to purchasers, ensuring that you get the exact specification of fixtures and fittings of your choice. This is a lovely, quiet village location with a local pub, parks and country walks, along with Chadderton Hall Park, St Matthews Church & Primary School as well as North Chadderton Secondary School all being within close proximity. The A627 motorway network connection & Mills Hill railway station just a short distance away.

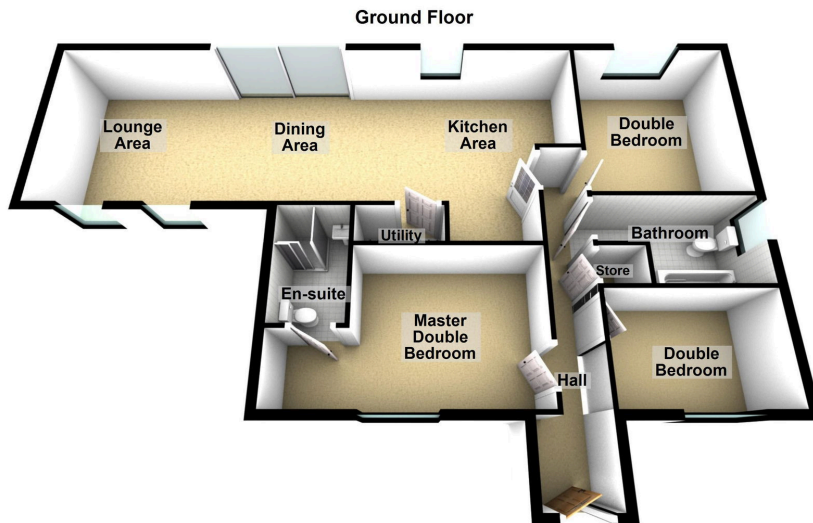
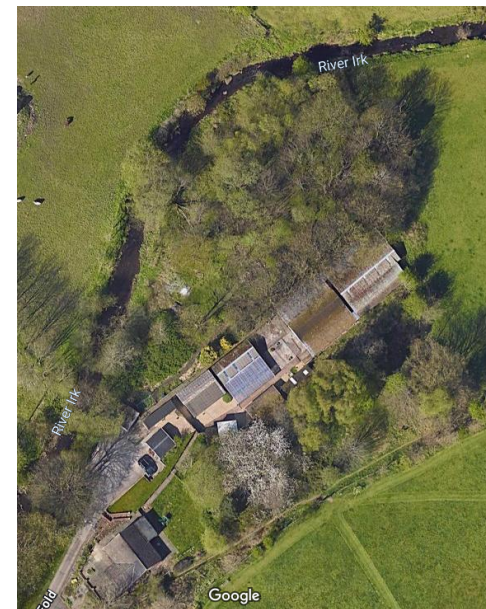

Chadderton Office

509 Middleton Road,
Chadderton, Oldham,
OL9 9SH

chadderton@kirkham-property.co.uk
t: 0161 626 5688