





6 Holme Crescent, Royton, Oldham, OL2 5BT

£299,950

🛏 3 🚿 1 🚗 2



- Detached Family Home
- Large Lounge/ Dining Room
- Great Location
- Garage
- Three Bedrooms
- Small Cul De sac
- Well Appointed Rear Garden
- EPC: C







NO CHAIN. Offered for sale is this lovely three bedroom detached family home located in this tucked away cul de sac in Royton. Accommodation comprising: Entrance hallway, large lounge/dining room, kitchen and a conservatory. To the first floor there are three bedrooms ( two with fitted wardrobes) and a bathroom. Externally there is an enclosed rear garden, garage and a two car driveway. Gas radiator central heating and uPVC double glazing throughout. Located close to Royton and easy access to motorway networks.

Contact us today to arrange an appointment.

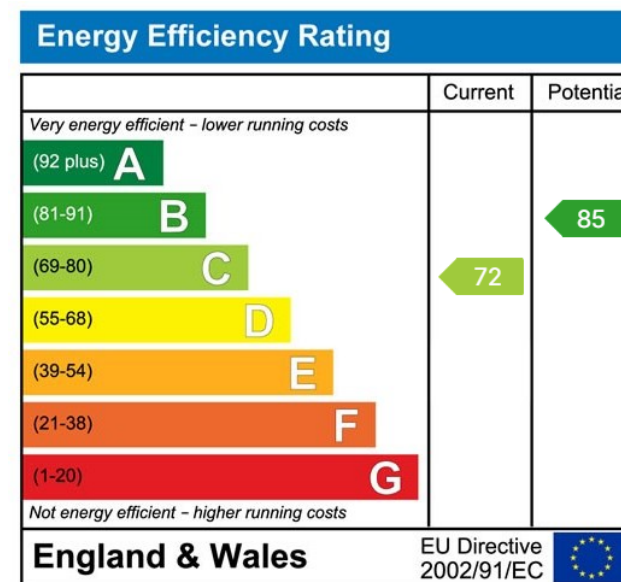
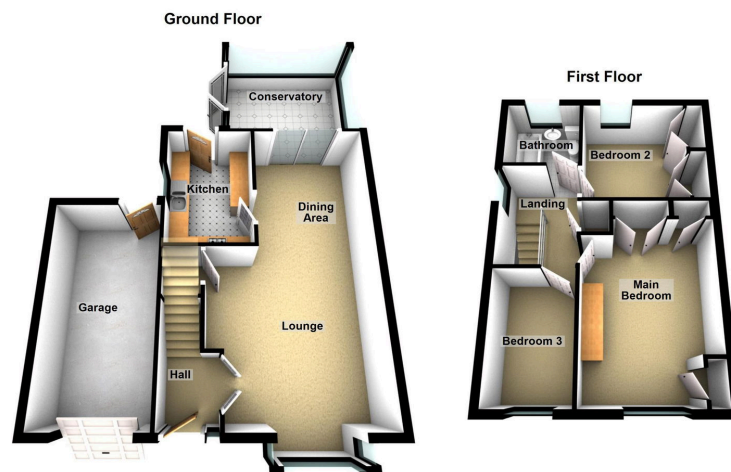

## Chadderton Office

509 Middleton Road,  
Chadderton, Oldham,  
OL9 9SH

chadderton@kirkham-property.co.uk  
t: 0161 626 5688