



24 Penthorpe Drive, Royton, Oldham, OL2 6JL

£269,950

🛏 3 🚿 1 🚗 3



- Extended Semi Detached Home
- Three Bedrooms
- Three Reception Rooms
- Lovely Grey Kitchen
- Great Location
- Private Rear Garden
- Superb Condition
- EPC:



Offered for sale is this lovely extended three bedroom semi detached family home located in this tucked away spot in Royton.

Accommodation comprising: Entrance porch, lounge, kitchen/ breakfast room, large conservatory and a versatile office/utility/ bedroom space.

To the first floor there are three good size bedrooms and a family bathroom.

Externally to the front is a good size two car block paved driveway. To the rear is an enclosed private garden.

Royton & Shaw town centres within easy reach as are local motorway networks.



W

T
is

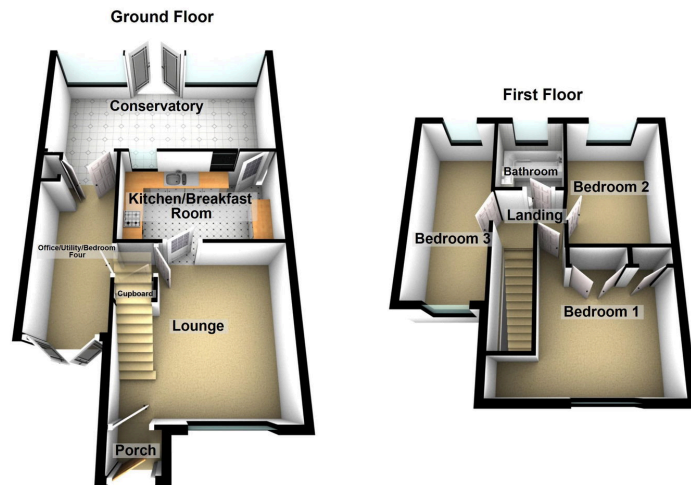

1g

Chadderton Office

509 Middleton Road,
Chadderton, Oldham,
OL9 9SH

chadderton@kirkham-property.co.uk
t: 0161 626 5688