





24a Grafton Street, Moorside, Oldham, OL1 4SD

£120,000

🛏 2 🚿 1 🛋 1



- No Chain
- Two Bedrooms
- Loft Room
- Great Location
- In Need Of Modernisation
- Close To Saddleworth
- Yard And Shed
- EPC:







NO CHAIN.

Offered for sale is this two bedroom mid terraced property located in this tucked away spot off Ripponden Road in Moorside.

In need of updating this property offers loads of potential as a home or as a buy to let.

Accommodation comprising: Vestibule, lounge and a good size kitchen/dining room.

To the first floor there are two bedrooms and a wet room. There is also a wooden staircase out of the main bedroom with access to a usable loft room.

Externally there is an enclosed vard and a brick built shed and



O  
C

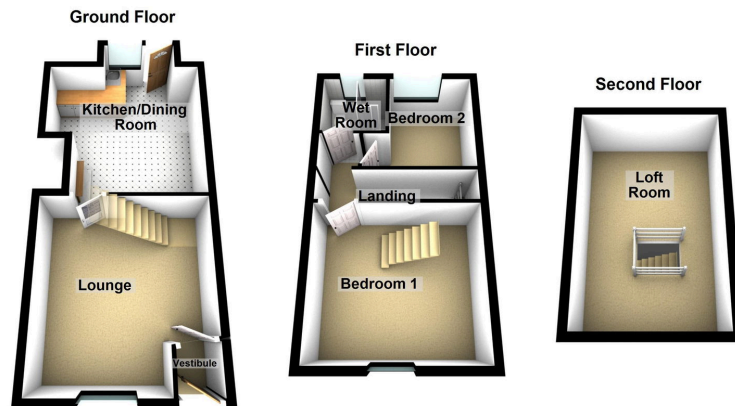

#### Chadderton Office

509 Middleton Road,  
Chadderton, Oldham,  
OL9 9SH

chadderton@kirkham-property.co.uk  
t: 0161 626 5688