







**580 Rochdale Road, Royton OL2 6SH**

**£189,950**

 2  1  2

- Character Terraced Home
- Two Bedrooms
- Close To Tandle Hill Country Park
- Two Reception Rooms
- Kitchen
- Close To Royton Center
- Garden & Side Access
- EPC:



Offered for sale is this lovely two bedroom end terraced property located within a short walk to Tandle Hill Country Park.

Accommodation comprising: Entrance hallway, lounge, living/ dining room and a kitchen.

To the first floor there are two bedrooms and a gorgeous bathroom.

Externally there is a garden/yard, cellar storage space underneath the house and on road parking.

Short walk also in to Royton centre. Motorway networks within easy reach.

Contact us to today to view what could be your new home.







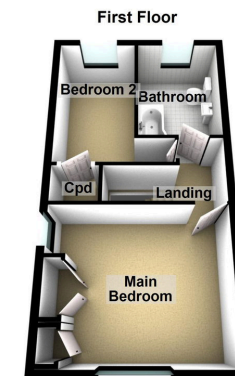
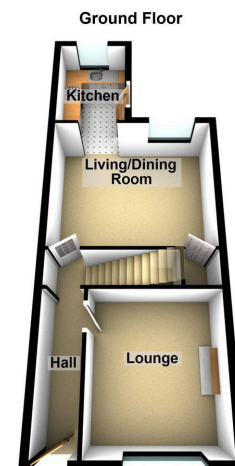

## Chadderton Office

509 Middleton Road,  
Chadderton, Oldham,  
OL9 9SH

chadderton@kirkham-property.co.uk  
t: 0161 626 5688