



44 Sheepfoot Lane, Boundary Park, Oldham, OL1 2PD

£245,000

🛏️ 2 🍳 1 🛋️ 1



- No Chain
- Extended
- Two Bedrooms
- Large Kitchen/Dining Room
- Super Condition
- Large Lounge
- Garage & Rear Garden
- EPC:



NO CHAIN.

Kirkham Property present this lovely two bedroom semi detached true bungalow located in the Boundary Park Area..

Accommodation comprising: Entrance hallway, lounge, large kitchen/dining room, two bedrooms and a shower room.

Externally there is a driveway, garage and a generous rear garden

Local shops and amenities within easy reach.

Offered in excellent condition throughout.

Contact us today to arrange a viewing.

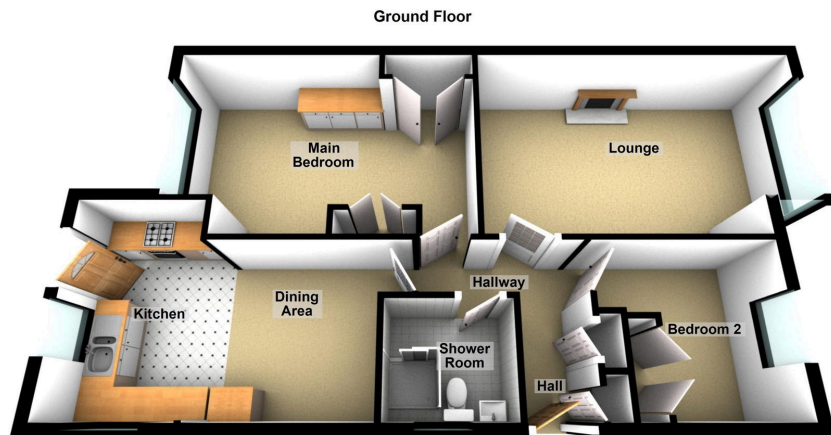

Chadderton Office

509 Middleton Road,
Chadderton, Oldham,
OL9 9SH

chadderton@kirkham-property.co.uk
t: 0161 626 5688