

3 Briony Close, Royton, Oldham, OL2 5AL

£185,000

🛏 2 🚿 1 🚗 1



- Semi-Detached Property
- Two Bedrooms
- Modern Development
- In Demand Location
- Kitchen/Diner
- Gardens Front & Rear
- Driveway Parking
- EPC Rating - D
-
-

Ground Floor

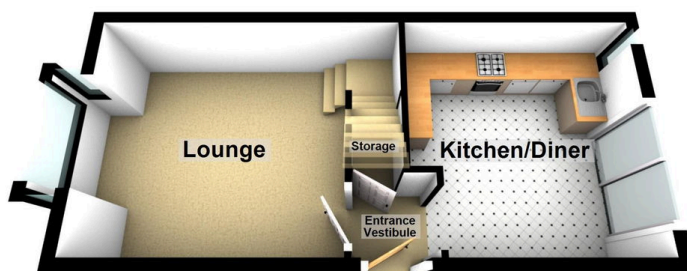

First Floor

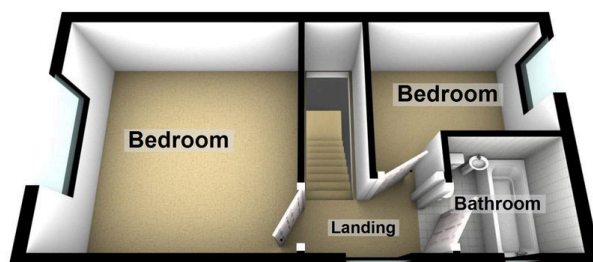

For sale is this well presented, Two Bedroom Semi-Detached Property, situated in a popular area of Royton located within close proximity for all local amenities (including Royal Oldham Hospital) and transport links including the motorway network.

The property's accommodation briefly comprises of:- Entrance Vestibule, Lounge and Kitchen/ Diner to the Ground Floor with Two Bedrooms and a Bathroom to the First Floor.

With uPVC Double Glazing and Gas Central Heating throughout.

Externally, there is a garden area to the front and gated access to the side of the property leading to a generous enclosed paved garden area with shed. Furthermore there is also gated access from the rear garden to a driveway providing off-road parking.

Viewing is highly recommended to truly appreciate this property.