



14 Whitehead Street, Shaw, OL2 7NL

£319,950

3 1 1



- Semi Detached
- Large Bathroom
- Well Appointed Garden
- Close To Well Respected Schools
- Three Good Bedrooms
- Massive Kitchen/Dining Room
- Lovely Condition Throughout
- EPC:



Offered for sale is this lovely three bedroom semi detached family home located in this popular spot in High Crompton.

Local Junior and Senior quality schools with in a short walk.

Accommodation comprising: Entrance porch/Hallway, large lounge, massive kitchen/dining room, utility area and a WC. To the first floor there are three good size bedrooms and a four piece bathroom.

Externally there is a well appointed garden with side access.

Shaw centre not too far away as is the local Metro stop direct in to Manchester.

Contact us today to arrange a viewing.

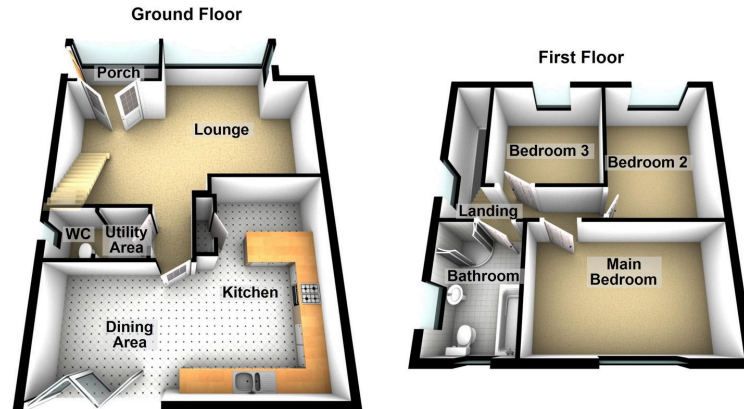

Chadderton Office

509 Middleton Road,
Chadderton, Oldham,
OL9 9SH

chadderton@kirkham-property.co.uk
t: 0161 626 5688