



65 Highfield Drive, Royton, OL2 6AF.

£439,950

🛏 4 🚿 3 🛋 4

- Executive Detached Family Home
- Two Bathrooms
- Large Kitchen/Breakfast Room
- Stunning Size Rear Garden
- Four/Five Bedrooms
- Three/Four Reception Rooms
- Immaculate Condition Throughout
- EPC: C



Offered for sale is this beautifully presented four bedroom executive detached house located in this tucked away Cul-de-sac in Royton. The finish on this lovely home is to a high standard and viewing will be the only way to fully appreciate it. The property is close to all local amenities and motorway networks. Accommodation comprising of: Entrance hallway, WC, lounge, dining room, kitchen/breakfast room, utility room, conservatory and a converted garage offering versatile usage. To the first floor there are four good size bedrooms (master En-suite) and a family bathroom. The property is offered with a much bigger plot than usual therefore benefitting from a large rear garden and side. Contact us today to arrange a viewing.



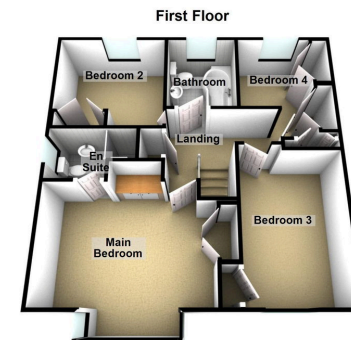
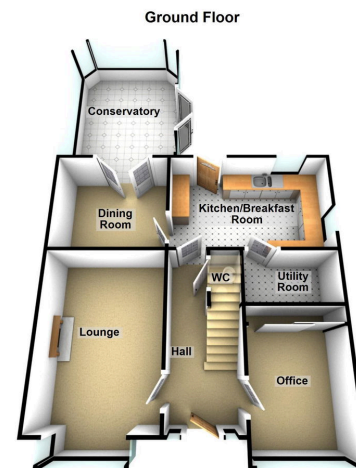

Chadderton Office

509 Middleton Road,
Chadderton, Oldham,
OL9 9SH

chadderton@kirkham-property.co.uk
t: 0161 626 5688