



84 Alt Lane, Oldham

£230,000

🛏 2 🚿 1 🛋 2

- Extended Semi Detached
- Two Double Bedrooms
- Through Lounge/Dining
- Good Size Kitchen
- Stunning Views To Rear
- Potential To Extend (subject to planning)
- Garage and Parking
- EPC - D



With STUNNING OPEN VIEWS to the rear and offered for sale with NO CHAIN therefore VACANT POSSESSION on completion is this extended two double bedroom semi detached property. This much loved family home is situated in a popular location that gets the best of both worlds of access to Ashton and Oldham centres and peaceful open countryside. With the potential to extend even further (subject to planning permission) the good size living space comprises of, to the ground floor entrance hallway, through lounge/dining and a superb extended modern kitchen with ample wall and base units. Off the first floor landing there are two double bedrooms and a family bathroom. Externally there is a driveway to the front providing off road parking leading to an attached single garage, whilst to the rear there is a lovely low maintenance garden with breath taking far reaching views. Viewing is a must.



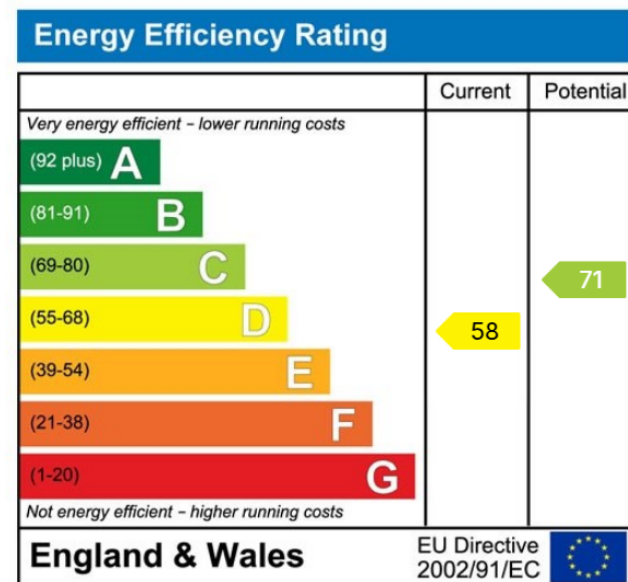
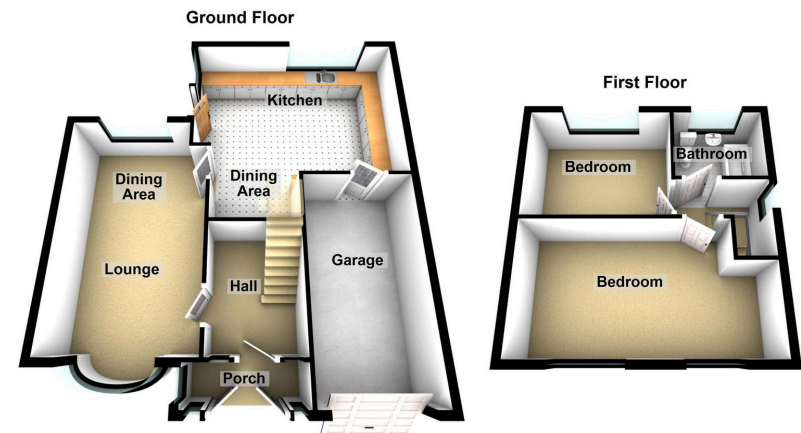

Chadderton Office

509 Middleton Road,
Chadderton, Oldham,
OL9 9SH

chadderton@kirkham-property.co.uk
t: 0161 626 5688