





3 Bromley Street, Chadderton

£325,000

🛏 3 🚿 2 🛋 2



- Extended Semi Detached
- Three Bedrooms
- Versatile Accommodation
- Large Plot
- Excellent Potential
- Superb Family Home
- Additional Land To Side
- EPC - tbc





Situated on a little known cul de sac just off Turf Lane is this unique extended three bedroom semi detached property. On a good size plot, with additional land to the side there is potential to extend even further (subject to planning). Offering excellent potential to provide a superb family home for years to come. Internally the spacious versatile accommodation comprises entrance porch, hallway, office/playroom (or could be used as an additional bedroom) with own separate front door access, through lounge dining, kitchen diner, sun room and wc. Off the first floor landing there three good size bedrooms (one with En-suite), office and a family bathroom. The front of the property is gated with a resin drive providing off road parking and an artificial lawn. To the side is an artificial lawn, Indian stone paving and a shed/workshop and a further plot of land and to the rear an artificial lawn and patio. Viewing is a must to appreciate the property!

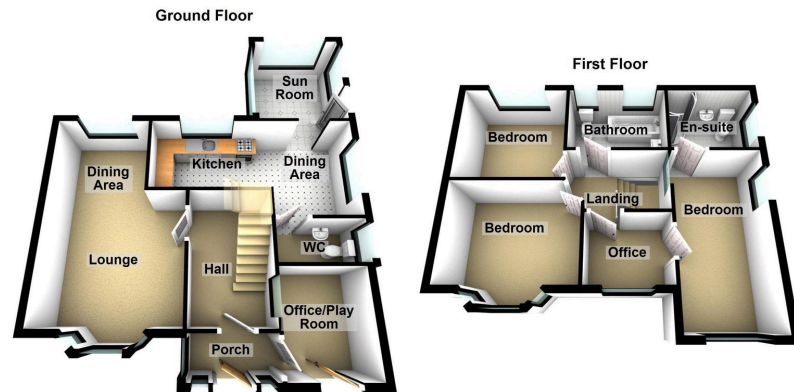

#### Chadderton Office

509 Middleton Road,  
Chadderton, Oldham,  
OL9 9SH

chadderton@kirkham-property.co.uk  
t: 0161 626 5688