



9 Bridge Street, Springhead, Oldham, OL4 4PE

£198,000

🛏 2 🚿 1 🛋 1

- NO VENDOR CHAIN
- Two Double Bedrooms
- Well Proportioned
- Generous Rear Garden
- Mid-Terrace Property
- Immaculately Presented
- Sought After Location
- EPC Rating - D



NO VENDOR CHAIN - An immaculately presented, characterful, period Mid-Terraced Cottage situated in Springhead, Oldham, conveniently located for access to Lees Village offering an array of local amenities including shops, schools and public transport links to the surrounding areas including Saddleworth and Oldham Town Centre.

The spacious internal accommodation briefly comprises of:- Lounge and Kitchen/Diner to the Ground Floor along with Two Large Bedrooms and Bathroom to the First Floor.

Externally there is a generous enclosed paved garden area to the rear.

The property is ideal for first time buyers.

Viewing of this property is essential.



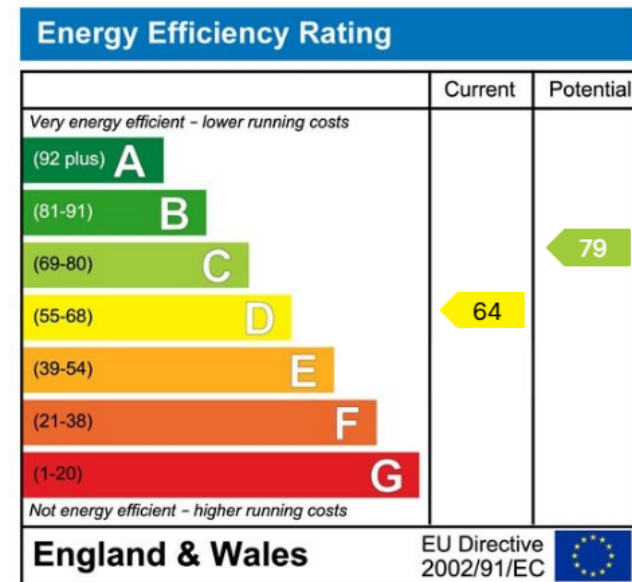
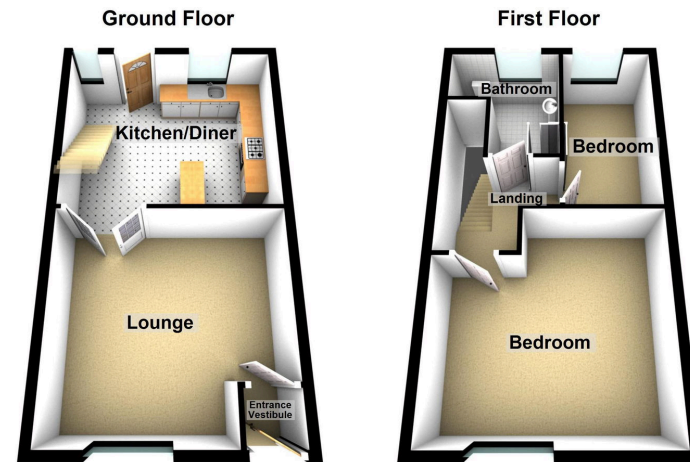

Chadderton Office

509 Middleton Road,
Chadderton, Oldham,
OL9 9SH

chadderton@kirkham-property.co.uk
t: 0161 626 5688