



41 Otmoor Way, Royton, OL2 6SD

Offers Over £300,000

🛏 2 🍳 1 🚿 2

- No Chain
- 2/3 Bedroom Bungalow
- Detached
- Lovely Condition Throughout
- Large Kitchen/Dining Room
- Shower/Wet Room
- Good Size Garden
- EPC:



NO CHAIN. Offered for sale in immaculate condition throughout is this beautiful detached true bungalow located in this tucked away position.

Close to both Royton & Shaw centres. This lovely home has been extended and viewing is highly recommended.

Accommodation comprising: Entrance hallway, lounge, kitchen/dining room, conservatory, two/three bedrooms, dressing room/ bedroom three and a shower/wet room.

Externally there is a good size garden to the rear which is very private. To the front is a driveway and ample space. Motorway networks and the local Metro station within easy reach.



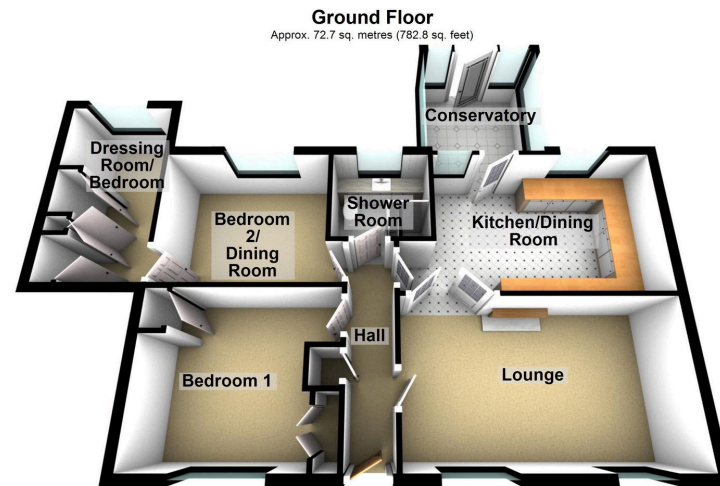

Total area: approx. 72.7 sq. metres (782.8 sq. feet)



Energy Efficiency Rating		
	Current	Potential
Very energy efficient – lower running costs		
(92 plus) A		108
(81-91) B		
(69-80) C		
(55-68) D	65	
(39-54) E		
(21-38) F		
(1-20) G		
Not energy efficient – higher running costs		
England & Wales	EU Directive 2002/91/EC	

Chadderton Office

509 Middleton Road,
Chadderton, Oldham,
OL9 9SH

chadderton@kirkham-property.co.uk
t: 0161 626 5688