



## 3 Willowfield Road, Moorside

Offers Over £195,000

🛏️ 3 🚿 1 🚗 1



- No Chain
- Three Bedrooms
- Good Size Lounge
- Garage & Garden
- Semi Detached Family Home
- Large Kitchen/Dining Room
- Great Views
- EPC: E



NO CHAIN. Built in 1971 and located in this elevated position is this lovely three bedroom semi detached family home.

Accommodation comprising: Entrance hall, lounge, kitchen/ dining room. To the first floor are three bedrooms and a family bathroom. Externally there is a rear garden, garage and a three car driveway.

Searching views towards Manchester and beyond. This property has been owned by the same family since it was built.

Call us today to arrange a viewing.

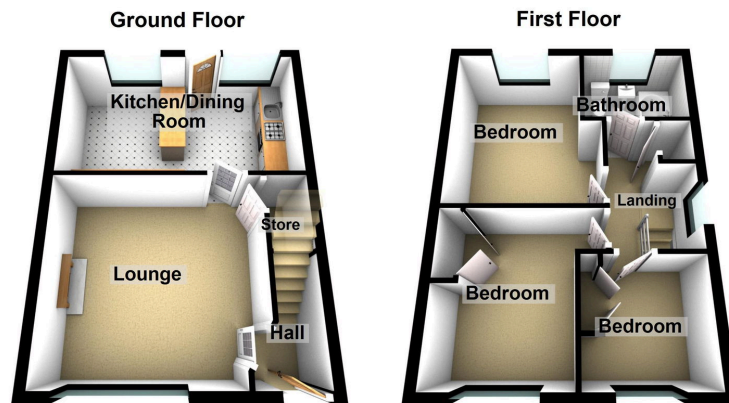

**Chadderton Office**

509 Middleton Road,  
Chadderton, Oldham,  
OL9 9SH

chadderton@kirkham-property.co.uk  
t: 0161 626 5688