



6 Spinners Way, Moorside, Oldham

Offers Over £325,000

🛏️ 4 🚿 2 🛋️ 2



- Cul De Sac Location
- Four Bedrooms
- Two Bathrooms
- Good Size Garden
- Impressive Detached Family Home
- No Chain
- Two Reception Rooms
- EPC: B



NO CHAIN. Offered for sale is this lovely four bedroom detached family home located in this sought after cul-de-sac in Moorside. Located on the cusp of Saddleworth therefore benefitting from superb local walks. Accommodation comprising: Entrance porch, hallway, large lounge, cloakroom/ WC, dining room and a kitchen. To the first floor is a large gallery landing, master bedroom with En-suite shower room, three further bedrooms and a family bathroom. Externally is a south facing rear garden, integral garage and a large driveway. The property has uPVC double glazing throughout and gas radiator central heating. Call us today to arrange a viewing.

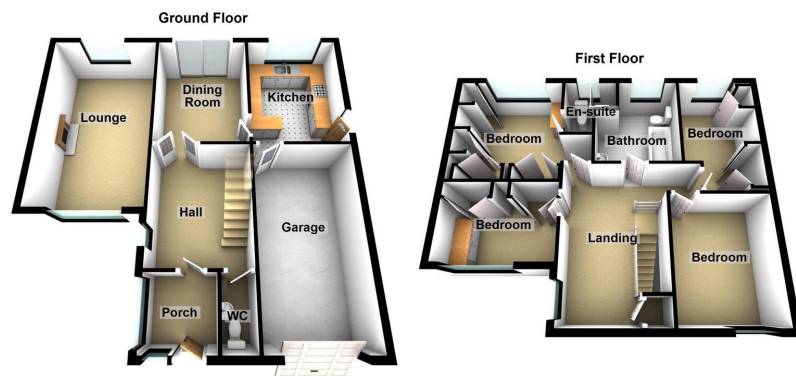

Energy Efficiency Rating		
	Current	Potential
<i>Very energy efficient - lower running costs</i>		
(92 plus) A		
(81-91) B		83
(69-80) C		
(55-68) D	61	
(39-54) E		
(21-38) F		
(1-20) G		
<i>Not energy efficient - higher running costs</i>		
England & Wales	EU Directive 2002/91/EC	

Chadderton Office

509 Middleton Road,
Chadderton, Oldham,
OL9 9SH

chadderton@kirkham-property.co.uk
t: 0161 626 5688