



24 Shore Avenue, Shaw

£299,950

🛏️ 2 🚿 1 🚗 1



- Extended True Bungalow
- Two Bedrooms
- Utility Room
- Good Size Garden
- Lovely Kitchen/Dining Room
- Fitted Wardrobes
- Four Piece Bathroom
- EPC:



Wow! Just Wow! Come and have a look at this one. What a lovely bungalow, offered in superb condition throughout is this extended two bedroom true bungalow located in one of Shaw's most sought after roads. Accommodation comprising of; Entrance porch, large hallway, lounge, large extended kitchen/ dining/living room, utility room, W.C, four piece bathroom and two good size bedrooms. Externally is a good size garden with a large raised deck area and plenty of space. Driveway parking for 4/5 cars. Call us today to view this lovely home, we are sure you wouldn't be disappointed.

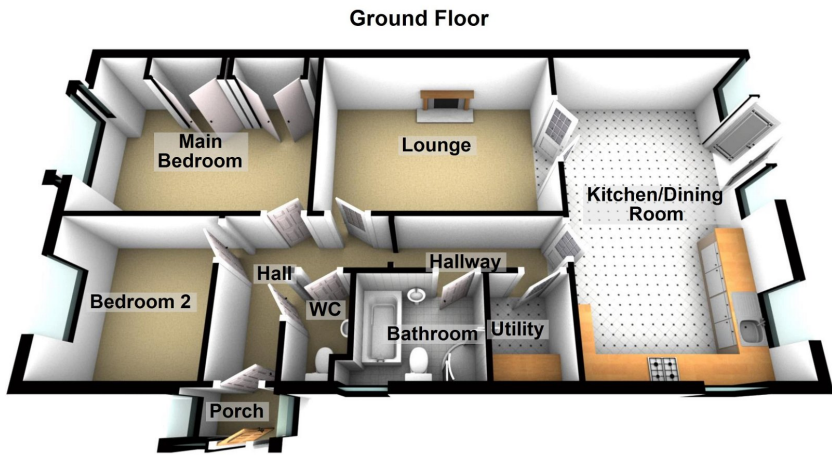

Chadderton Office
509 Middleton Road,
Chadderton, Oldham,
OL9 9SH

chadderton@kirkham-property.co.uk
t: 0161 626 5688