



482 Rochdale Road, Royton

Offers Over £200,000

🛏️ 2 🚿 1 🛋️ 2



- Mid Terrace
- Two Double Bedrooms
- Two Reception Rooms
- Excellent Potential
- Ideal FTB or Young Family Home
- Popular Location
- EPC - tbc



This is particularly spacious bay fronted, two double bedroom, two reception room terrace property. Offering good size living accommodation for either the first time buyer or young family. The property is situated in a popular & convenient residential area with easy access to Royton centre, well regarded local schools & amenities. Offering excellent potential the living space comprises of entrance hallway, lounge, separate dining/ sitting room and kitchen to the ground floor whilst off the first floor landing there are two double bedrooms and a family bathroom. Outside there is an enclosed area to the front, and rear with a further garden plot beyond the rear garden. The property benefits further from the installation of gas fired central heating (with a new boiler being installed within the last 5 years) and is mainly double glazed and retains mainly of the original and period features.

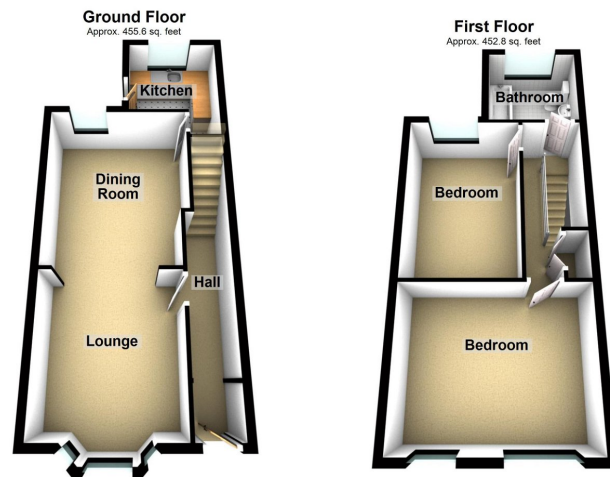

Total area: approx. 908.4 sq. feet

Chadderton Office

509 Middleton Road,
Chadderton, Oldham,
OL9 9SH

chadderton@kirkham-property.co.uk
t: 0161 626 5688