



19 Armdale Rise, Waterhead

Offers Over £260,000

🛏 3 🚿 1 🚗 1



- Detached Property
- Three Storey
- Commanding Views
- Large Integral Garage
- Three Bedrooms
- Elevated Position
- Useful Basement
- EPC Rating - D



Excellent positioned family home on a quiet col-de-sac, with commanding views from the Peak District to Snowdonia. Ideally situated close to schools and essential amenities, this detached home has ample space for families to enjoy the privacy of this location, as the property is not overlooked by neighbours.

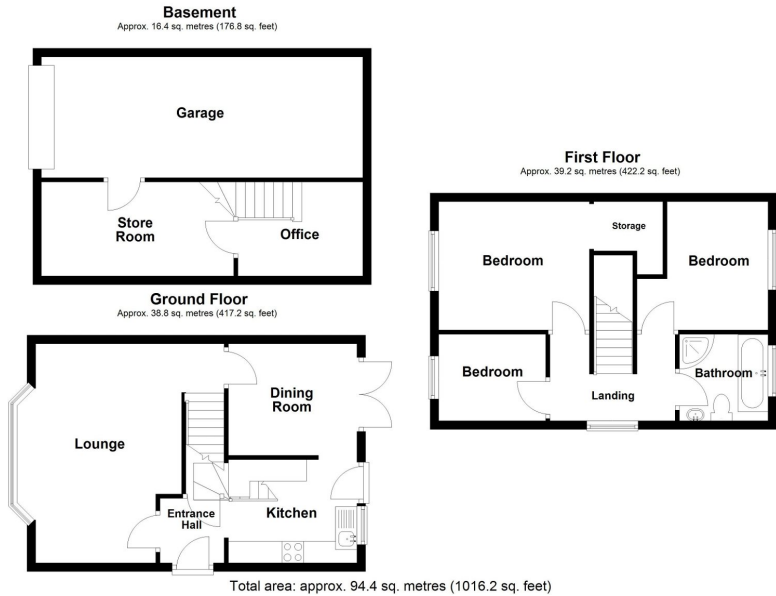

Score	Energy rating	Current	Potential
92+	A		
81-91	B		85 B
69-80	C		
55-68	D	60 D	
39-54	E		
21-38	F		
1-20	G		

Chadderton Office
509 Middleton Road,
Chadderton, Oldham,
OL9 9SH

chadderton@kirkham-property.co.uk
t: 0161 626 5688