



300 Rochdale Road, Royton

£134,950

🛏️ 2 🚿 1 🚗 1



- No Chain
- Two Bedrooms
- Large Kitchen/Dining Room
- In Need Of Modernsation
- Close To Royton
- Investors / First Time Buyers
- Overlooking Dogford Park
- EPC:



NO CHAIN. Offered for sale is this two bedroom terraced property located close to Royton town centre. In need of full renovation. Accommodation comprising: Entrance vestibule, lounge, kitchen/dining room, utility room, WC and a rear porch. To the first floor there are two bedrooms and a bathroom. Externally to the rear is a double gated yard and a small courtyard garden to the front. This property overlooks Dogford park therefore has scenic views. Contact us today to arrange a viewing. Don't miss out.

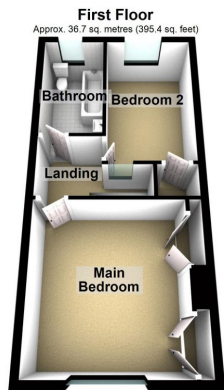
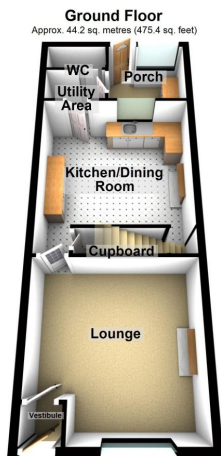

Total area: approx. 80.9 sq. metres (870.8 sq. feet)

