



18 Parklands, Royton

Offers Over £470,000

🛏️ 4 🚿 2 🛋️ 2

- Executive Detached Family Home
- Tandle Hills Location
- Private Garden
- Solar Panel System
- 4/5 Bedrooms
- Two/Three Reception Rooms
- Very Well Presented Throughout
- EPC:



Offered for sale with no chain is this lovely four/five bedroom detached family home located close to Tandle Hill Country Park in Royton. Accommodation comprising: Entrance hallway, large lounge, dining room, kitchen, W.C and a playroom/bedroom. To the first floor there are four bedrooms, master with en suite shower room and a family bathroom. Externally there is a private south facing rear garden and a good size driveway to the front. To property is located at the head of an elevated cul se sac. Call us today to arrange a viewing on this wonderful home.



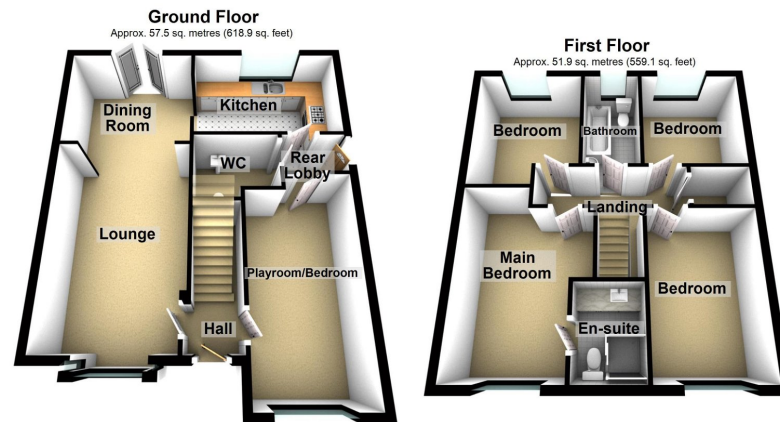

Total area: approx. 109.4 sq. metres (1178.0 sq. feet)

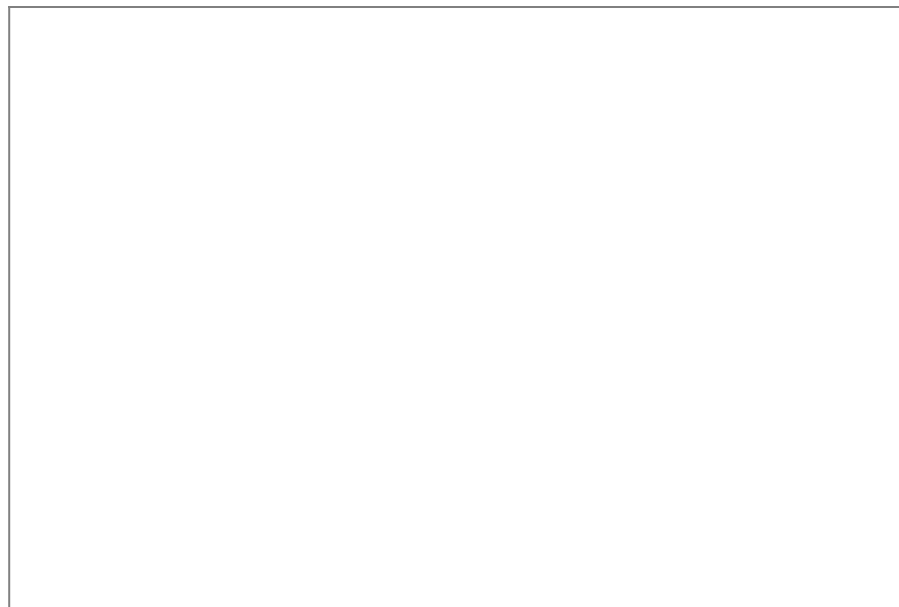

Chadderton Office
509 Middleton Road,
Chadderton, Oldham,
OL9 9SH

chadderton@kirkham-property.co.uk
t: 0161 626 5688