



# Cambrian Drive, Royton

£189,950

3 1 1



- No Chain
- Great Location
- Extended Kitchen
- Garage And Driveway
- Three Bedroom End Town House
- Large Lounge/ Dining Room
- Royley Estate
- EPC:



NO CHAIN. Offered for sale is this extended end town house located in the popular 'Royley' development in Royton. Accommodation comprising: Entrance hall, lounge, dining area and an extended kitchen. To the first floor are three bedrooms and a family bathroom. The property is in need of updating but has been priced accordingly. Externally is a garage and a garden. Royton town centre within a short walk and also has excellent access routes for the motorway network. Call us today to arrange a viewing.

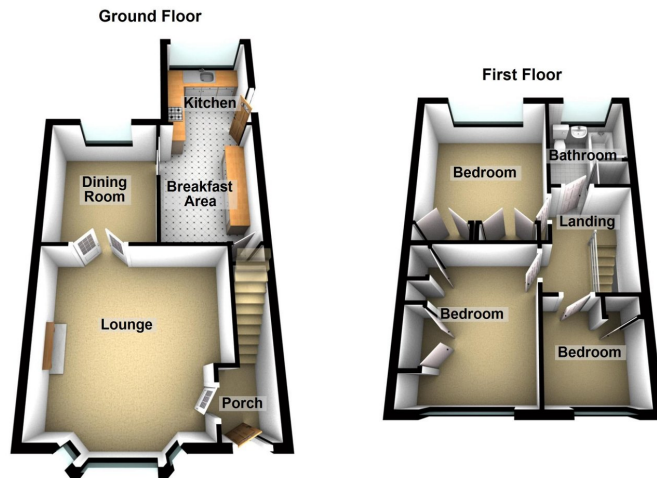

Total area: approx. 911.9 sq. feet

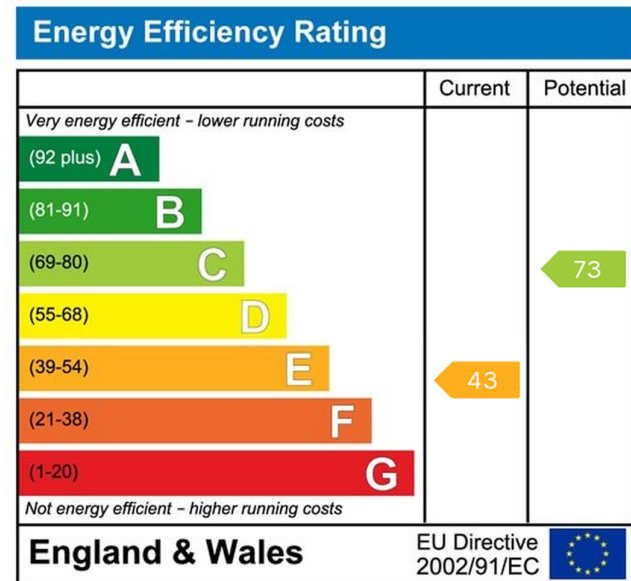

**Chadderton Office**

509 Middleton Road,  
Chadderton, Oldham,  
OL9 9SH

chadderton@kirkham-property.co.uk  
t: 0161 626 5688