



Hawkshead Drive, Royton

Offers Over £259,950



ALL. TOGETHER. BETTER.

www.kirkham-property.co.uk

Hawkshead Drive, Royton

Offered for sale is this very well presented three bedroom semi detached family home in this tucked away spot just off Grasmere road in Royton. Also within close proximity of the award winning Tandle Hill Country Park, motorway networks and Royton town centre itself. Accommodation comprising: Entrance hallway, lounge, dining room, kitchen and a conservatory. To the first floor are three bedrooms and a good size family bathroom. Externally a lovely south facing rear garden and to the front a driveway for two cars. Call us today to arrange a viewing of what could be your new home.





NOTE: There is information available on OMBC website regarding a property on Hawkshead Drive in relation to the proposed use of the property - please see link for full details - <https://planningpa.oldham.gov.uk/online-applications/applicationDetails.do?activeTab=summary&keyVal=S60QV1MCMKW00> or ask for the details to be sent via PDF on email.



Ground Floor

Approx. 52.2 sq. metres (561.9 sq. feet)

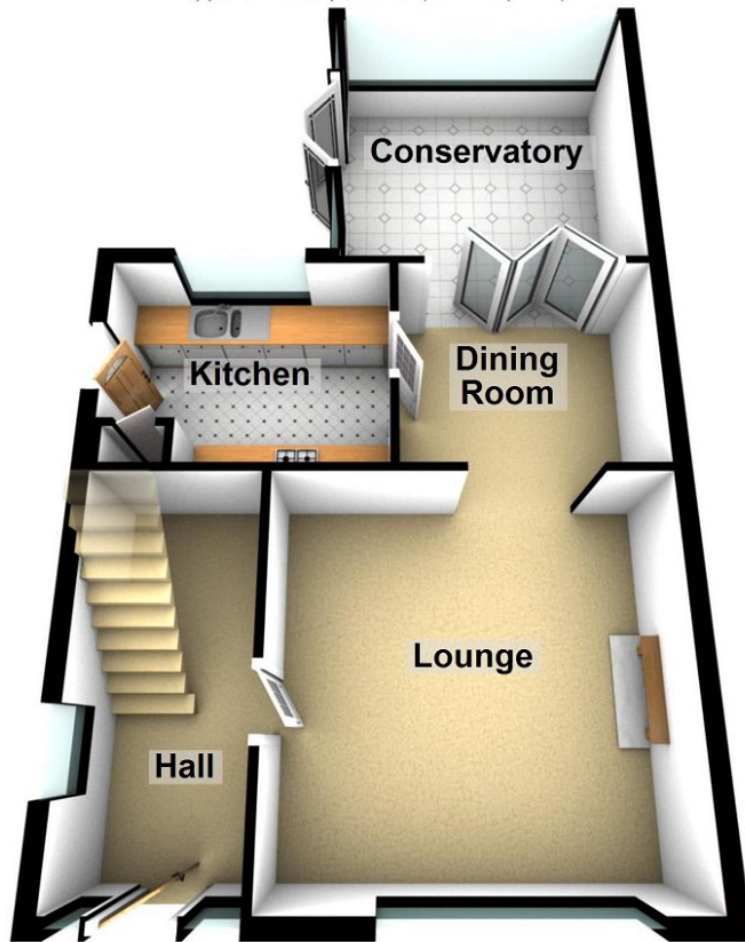

First Floor

Approx. 36.7 sq. metres (395.5 sq. feet)

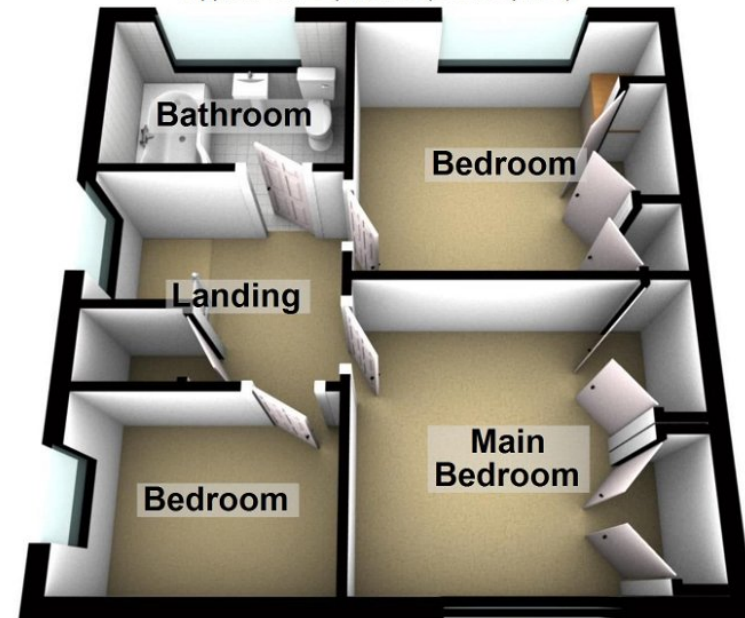

Total area: approx. 88.9 sq. metres (957.4 sq. feet)

Chadderton Office

509 Middleton Road,
Chadderton, Oldham,
OL9 9SH

chadderton@kirkham-property.co.uk
t: 0161 626 5688