





742 Ripponden Road, Oldham

£279,950

🛏️ 4 🚿 2 🛋️ 2



- No Chain
- Close To Saddleworth
- Master En Suite
- Garden And Parking
- Stone Semi Detached Family Home
- Four Bedrooms
- Open Plan Living
- EPC:

**NO CHAIN.** Offered for sale is this gorgeous stone built four bedroom semi detached family home located within a stones throw of Saddleworth. Accommodation comprising: Entrance hallway, open plan kitchen/dining room, lounge and a cloakroom/WC. To the first floor are three bedrooms and a bathroom. To the second floor is a master suite that offers superb searching views, dressing area and a large En-suite shower room. Externally a private rear garden and gated allocated parking for two cars. Call us today to arrange an appointment.

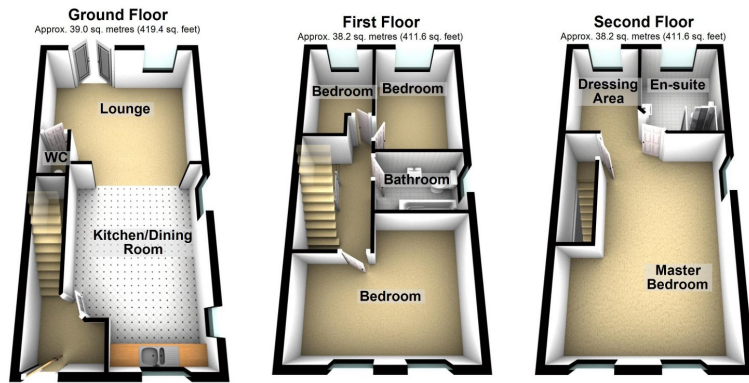

Total area: approx. 115.4 sq. metres (1242.6 sq. feet)

Score	Energy rating	Current	Potential
92+	A		94 A
81-91	B	85 B	
69-80	C		
55-68	D		
39-54	E		
21-38	F		
1-20	G		

**Chadderton Office**  
 509 Middleton Road,  
 Chadderton, Oldham,  
 OL9 9SH

Monday – Friday. 9am – 5pm  
 Saturday. 10am – 3 pm  
 chadderton@kirkham-property.co.uk  
 t: 0161 626 5688  
 f: 0161 628 0350

Out of hours telephone service  
 Monday – Thursday 8:30am – 7pm  
 Friday – 8:30am – 5pm  
 Saturday – Sunday 10am – 3pm