



Cinder Hill Lane, Chadderton

£575,000



ALL. TOGETHER. BETTER.

www.kirkham-property.co.uk

Cinder Hill Lane, Chadderton

Tucked away in an idyllic rural location is this three bedroom detached cottage. Rarely do opportunities of this nature come along to purchase a good size home on a large plot and in such a peaceful area! Beautifully appointed throughout, it will provide a superb family home for years to come. The property is generously proportioned throughout and ready to move straight into. Internally the house is over two floors, to the ground floor you will find an entrance porch, lounge with multi fuel burner, dining room, kitchen and downstairs wc. From the first floor landing there is access to three bedrooms, one of which has a modern en-Suite wet room, all bedrooms have the benefit of fitted wardrobes. There is also a family bathroom. Externally there is a large garden with mature trees and plants, a large lawned area plus patio areas and two gated driveways providing ample off road parking. Internal viewing is a must to appreciate this beautiful property.





Tucked away in an idyllic rural location is this three bedroom detached cottage. Rarely do opportunities of this nature come along to purchase a good size home on a large plot and in such a peaceful area! Beautifully appointed throughout, it will provide a superb family home for years to come. The property is generously proportioned throughout and ready to move straight into. Internally the house is over two floors, to the ground floor you will find an entrance porch, lounge with multi fuel burner, dining room, kitchen and downstairs wc. From the first floor landing there is access to three bedrooms, one of which has a modern en-Suite wet room, all bedrooms have the benefit of fitted wardrobes. There is also a family bathroom. Externally there is a large garden with mature trees and plants, a large lawned area plus patio areas and two gated driveways providing ample off road parking. Internal viewing is a must to appreciate this beautiful property.

ENTRANCE PORCH

LOUNGE

4.11m x 5m (13'6" x 16'5")

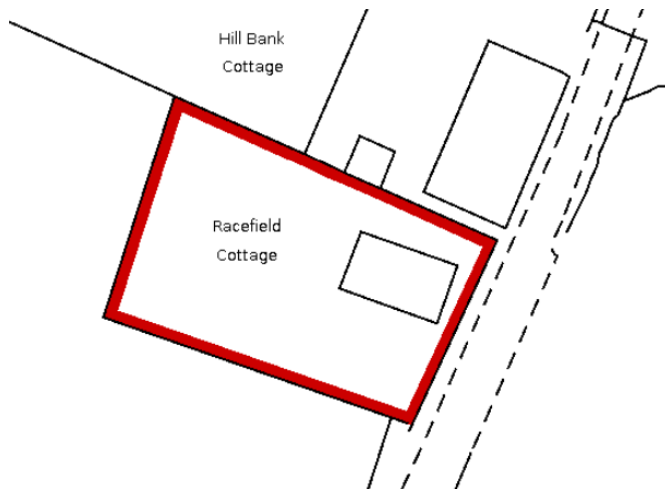

DINING ROOM

4.04m x 5m (13'3" x 16'5")

KITCHEN

2.24m x 5m (7'4" x 16'5")

DOWNSTAIRS WC



Ground Floor

Approx. 676.4 sq. feet

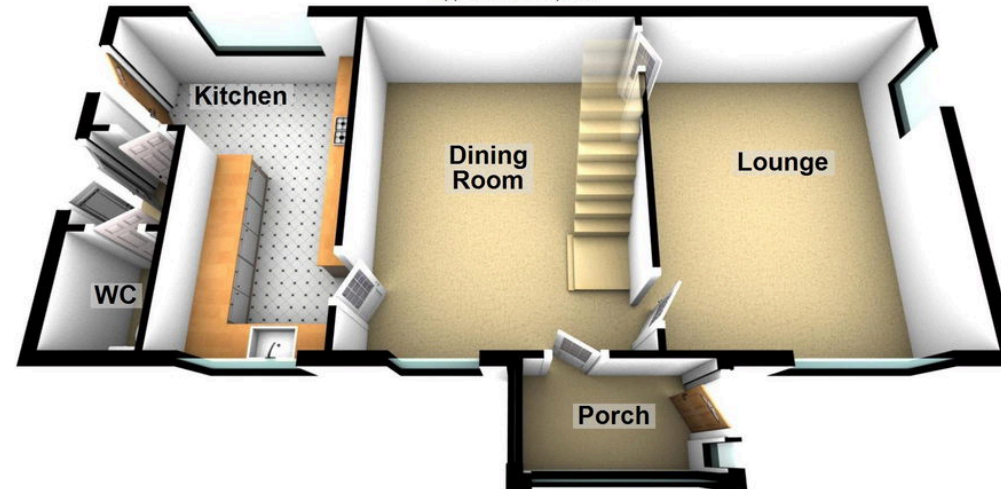

First Floor

Approx. 639.7 sq. feet

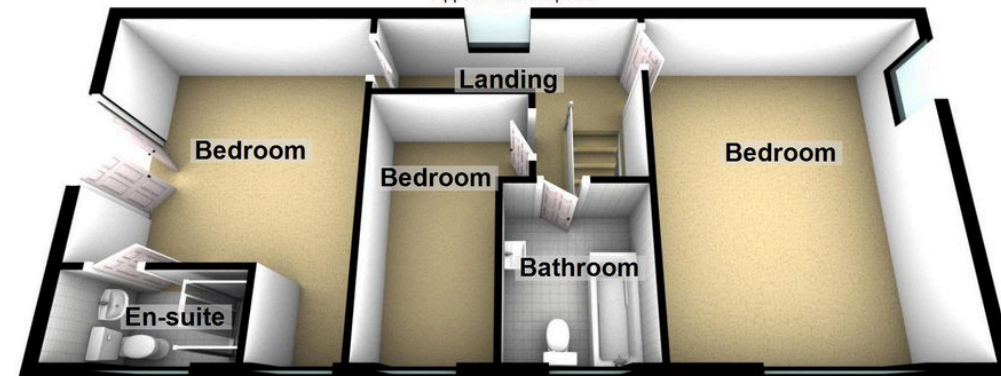

Total area: approx. 1316.1 sq. feet

Chadderton Office

509 Middleton Road,
Chadderton, Oldham,
OL9 9SH

chadderton@kirkham-property.co.uk

t: 0161 626 5688

www.kirkham-property.co.uk