



End Terraced Villa

2 Doon Place, Saltcoats, KA21 6EJ



2 Doon Place

Taylor & Henderson are delighted to present to the market this rarely available end terrace villa located within a residential pocket. The accommodation comprises entrance hallway, lounge, fitted kitchen with door to the rear garden and storage cupboard all on the ground floor. The upper level comprises 2 double bedrooms (1 with mirrored wardrobes and storage cupboard) single bedroom and bathroom with over bath shower. Features include double glazing, gas central heating and generous storage space. The front of property which boast a corner plot, driveway providing off road parking for more than 1 vehicle, section of lawn bounded by hedgerow. The enclosed rear garden has a section of lawn with a drying green, patio area to the side at the detached garage. Saltcoats offer a range of local amenities including beach, local shops, supermarket, restaurants, schools, train station and bus services. This excellent property is conveniently situated for all local amenities including road and rail links to Glasgow and all West Coast towns and thus is well located for travel throughout West Central Scotland.

Entrance Vestibule	7'9 x 10'7
Lounge	18'6 x 11'9
Kitchen	10'7 x 10'1
Bedroom 1	16'2 x 8'5
Bedroom 2	13'1 x 9'8
Bedroom 3	11'9 x 6'8
Bathroom	5'7 x 6'5
Garage	20'0 x 9'3

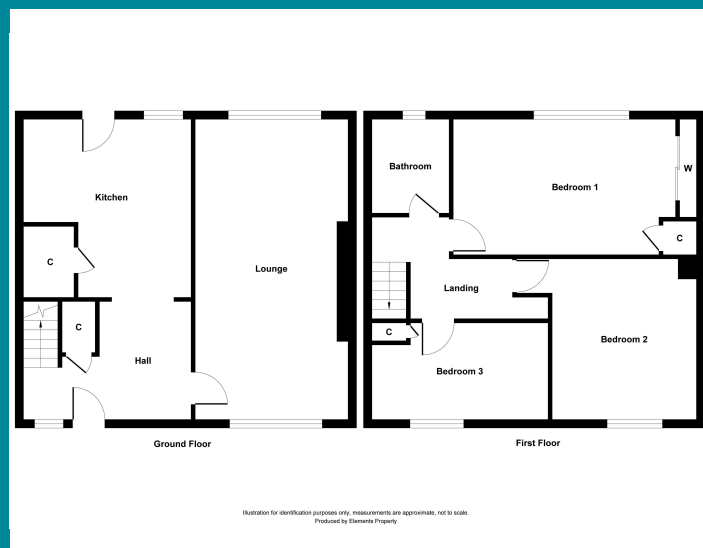
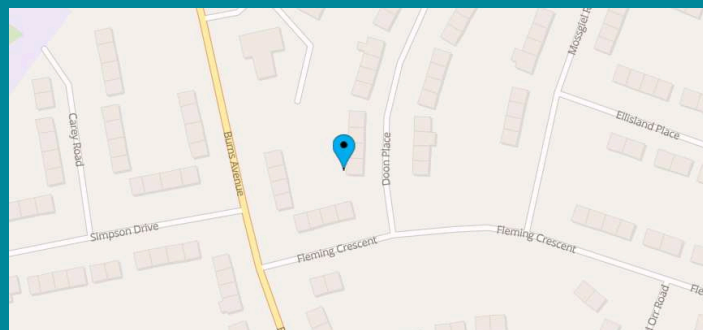

Viewing
Through solicitors on 01294 606700

Email
property@taylorandhenderson.co.uk

Reference E499834