



End Terraced Villa

36 Churchill Avenue, Kilwinning, KA13 7JN



36 Churchill Avenue

Taylor & Henderson are delighted to bring to the market this spacious end terrace villa located within an ever-popular, established residential pocket. The accommodation which has been freshly plastered throughout with new laminate flooring in the hallway and lounge comprises, hallway, storage cupboard under the staircase, lounge, kitchen with door to the rear garden all on the ground floor. The upper level comprises 2 double bedrooms (both with a built in cupboard) brand newly fitted bathroom suite with over bath shower. Features include double glazing, gas central heating and generous storage. The front garden has a driveway providing off street parking for 1 vehicle behind wrought iron gates, there is a path to the front door and section of lawn. The enclosed rear garden has a raised section of lawn with shrubs and trees and area for a garden shed. Kilwinning offers a wide range of local amenities to include shops, schooling at both primary and secondary levels, bus routes and excellent road links to both Glasgow and Ayr. Kilwinning also has mainline train links with Glasgow to the north and Ayr to the south. Glasgow and Prestwick Airport are 20 and 15 miles respectively with regular scheduled international flights.

Hall / Landing	9'3 x 6'3
Lounge	18'9 x 11'6
Kitchen	9'8 x 7'8
Bathroom	5'8 x 6'2
Bedroom 1	18'3 x 9'3
Bedroom 2	11'8 x 9'7

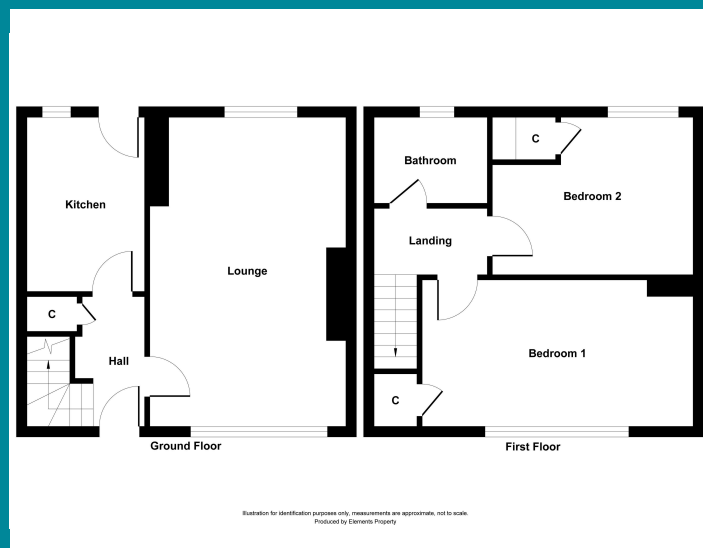
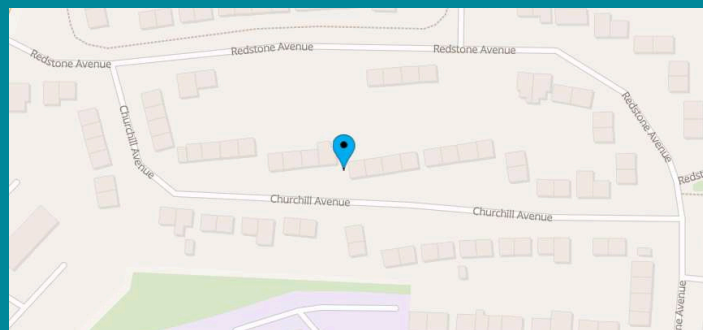

Viewing
Through solicitors on 01294 606700

Email
property@taylorandhenderson.co.uk

Reference E499567



rightmove

zoopla

OnTheMarket



DISCLAIMER: Whilst we endeavour to make these particulars as accurate as possible, they do not form part of any contract of offer, nor are they guaranteed. Measurements are approximate and in most cases are taken with a digital/sonic-measuring device and are taken to the widest point. We have not tested the electricity, gas or water services or any appliances. Photographs are reproduced for general information and it must not be inferred that any item is included for sale with the property. If there is any part of this that you find misleading or simply wish clarification on any point, please contact our office immediately when we will endeavour to assist you in any way possible.