



Terraced Villa

17 Gigha Place, Irvine, KA11 1DF



taylorandhenderson.co.uk



17 Gigha Place

Taylor & Henderson are delighted to bring to the market this mid terrace villa located within an established residential locale and easy access to amenities. The accommodation comprises entrance hallway, kitchen, w/ c, 2 generous storage cupboards, lounge with patio doors to the rear garden all on the ground floor. The upper level boasts 3 double bedrooms (1 with mirrored wardrobes) bathroom and another generous storage cupboard. The property further benefits from double glazing, gas central heating and ample storage throughout. The front garden has a step and stone effect pathway towards the front door with lawn around. There is hedgerow surrounding the front of the property and a gated entrance. The enclosed rear garden which is fully fenced in has a section of lawn with a paved path from the patio doors leading to the fence/gate. The property is conveniently situated within easy access of all local amenities, including local shops, sports and recreational facilities with Ravenspark Golf Course and Irvine Club Golf Course, schools and regular public transport services. Irvine offers good road and rail links to Glasgow, neighbouring Ayrshire towns and the M8 motorway network, thus providing ease of travel throughout West Central Scotland

Entrance Vestibule

Lounge

Kitchen

WC

Bathroom

Bedroom 1

Bedroom 2

Bedroom 3

19'7 x 12'2

12'3 x 6'6

4'8 x 2'7

9'5 x 5'6

12'4 x 9'9

9'8 x 9'5

9'6 x 8'8

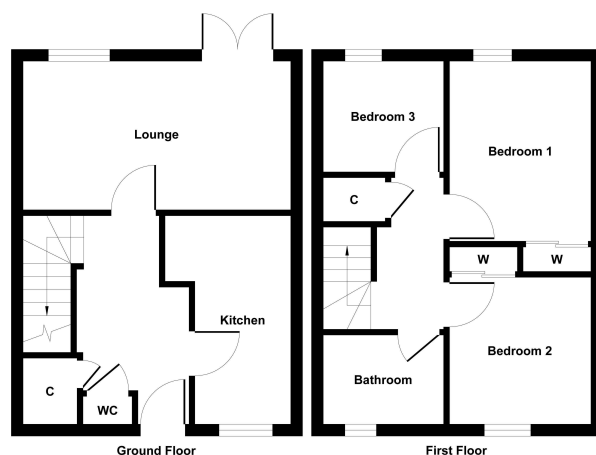
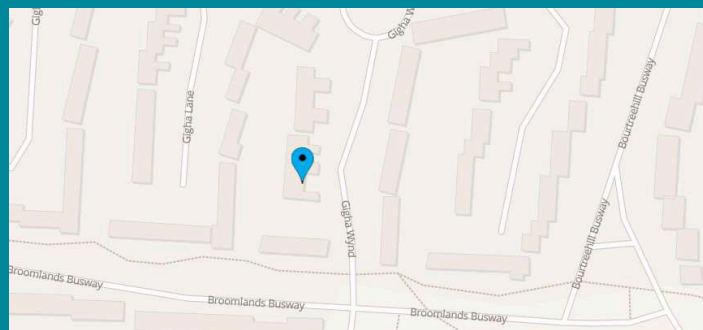

Illustration for identification purposes only, measurements are approximate, not to scale.
Produced by Elements Property

Viewing

Through solicitors on 01294 606700

Email

property@taylorandhenderson.co.uk

Reference E499615



rightmove

zoopla

OnTheMarket



Taylor
HENDERSON
PROPERTY LTD

DISCLAIMER: Whilst we endeavour to make these particulars as accurate as possible, they do not form part of any contract of offer, nor are they guaranteed. Measurements are approximate and in most cases are taken with a digital/sonic-measuring device and are taken to the widest point. We have not tested the electricity, gas or water services or any appliances. Photographs are reproduced for general information and it must not be inferred that any item is included for sale with the property. If there is any part of this that you find misleading or simply wish clarification on any point, please contact our office immediately when we will endeavour to assist you in any way possible.