



Semi-Detached Bungalow

49 High Road, Saltcoats,



taylorandhenderson.co.uk





49 High Road

Taylor & Henderson are delighted to offer to the market this rarely available semi detached extended bungalow located within a most desirable residential pocket easy access amenities.

The spacious family accommodation on a versatile layout currently comprises porch, hallway, lounge, 3 double bedrooms, modern shower room, extended dining kitchen with door to rear garden.

The property further benefits from double glazing, gas central heating and generous storage accommodation. The generous front garden is laid with lawn with 2 mature trees in the middle, there is a slabbed pathway to the front door and a driveway to the side of the property for more than 3 cars. Through double gates leads to the fully enclosed rear garden mainly laid with lawn and a timber garden shed.

Saltcoats and nearby Ardrossan offer a range of local amenities including a superb beach, local shops, supermarkets, restaurants, schools, leisure facilities, bus services and regular rail links to Glasgow and all West Coast towns and thus is well located for travel throughout West Central Scotland. There is also a regular ferry service to the Isle of Arran from Ardrossan Marina.

Early Viewing is Highly Recommended!

Measurements

Porch	3'5 x 3'1
Hallway	13'2 x 4'4
Lounge	15'2 x 11'9 (at widest points)
Bedroom 1	13'0 x 11'1
Bedroom 2	11'4 x 9'4
Bedroom 3	13'0 x 8'6
Kitchen Dining Room	18'8 x 10'7
Shower Room	6'3 x 6'0



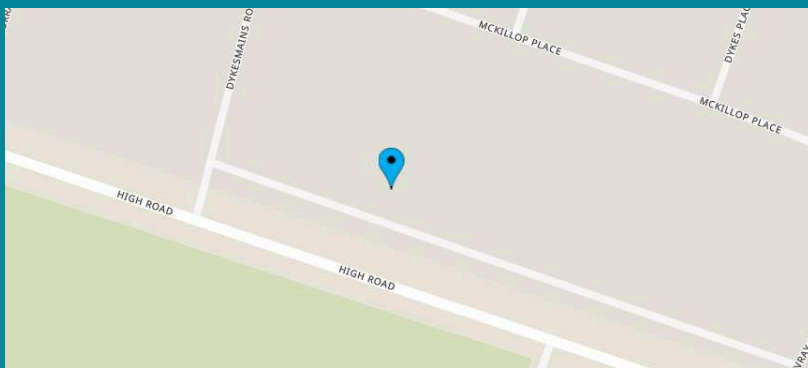

Viewing
Through solicitors on 01294 606700

Email
property@taylorandhenderson.co.uk

Reference
E477756

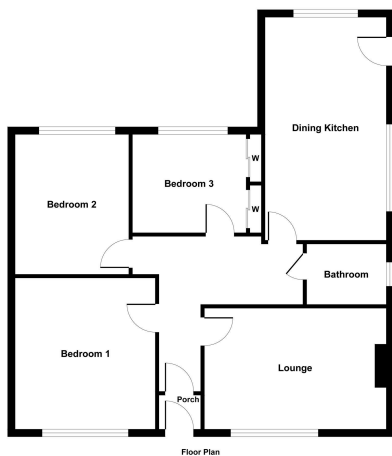

Illustration for identification purposes only. Measurements are approximate, not to scale.
Produced by Elements Property

Our Offices

51 Hamilton Street, Saltcoats, Ayrshire, KA21 5DX
Tel: 01294 606700 & Fax: 01294 464827

22 Bank Street, Irvine, Ayrshire, KA12 0AG
Tel: 01294 278306 & Fax: 01294 272886

83 Main Street, Kilwinning, Ayrshire, KA13 6AN
Tel: 01294 557506 & Fax: 01294 558552
Email: property@taylorandhenderson.co.uk

espc rightmove  zoopla  OnTheMarket



DISCLAIMER: Whilst we endeavour to make these particulars as accurate as possible, they do not form part of any contract of offer, nor are they guaranteed. Measurements are approximate and in most cases are taken with a digital/sonic-measuring device and are taken to the widest point. We have not tested the electricity, gas or water services or any appliances. Photographs are reproduced for general information and it must not be inferred that any item is included for sale with the property. If there is any part of this that you find misleading or simply wish clarification on any point, please contact our office immediately when we will endeavour to assist you in any way possible.