



Canonbury Place, Islington, London NI



Canonbury Place, Islington, London N1

A bright and airy, two bedroom lateral apartment in the heart of Canonbury. Located just steps away from the prestigious Canonbury Square, this exceptionally spacious and well-designed two bedroom flat is situated on the second floor of a well-maintained Victorian mansion block. The property is an exemplary blend of contemporary living and traditional charm, spanning over 1,100 sq ft of internal living space.

The flat is presented in excellent condition throughout and benefits from an abundance of natural light, thanks to the dual aspect of the large principal bedroom and the even more generously sized reception room. The well-proportioned and thoughtfully arranged fitted kitchen features Corian worktops and stripped original floorboards.



Guide price: £1,250,000

Tenure: Share of freehold plus leasehold, approximately 980 years remaining

Service charge: £1,800 per annum

Ground rent: Peppercorn

Local authority: London Borough of Islington

Council tax band: F





Additionally, the property has plenty of storage on offer with fitted wardrobes in the principal bedroom and access to an individual shed of 20 sq ft in the building's communal garden. Retaining many original features, including fireplaces, high ceilings, cornicing, original sash windows, and a Victorian tessellated tiled hallway floor, this is a rare gem to find in Canonbury. Furthermore, the property benefits from uninterrupted views across Canonbury. Please note that we have been unable to confirm the date of the next review for ground rent and service charge. You should ensure that you or your advisors make your own inquiries.

Location

Canonbury Square is a sought-after location in the heart of Islington. Upper Street with its myriad of shops, bars and restaurants are moments away and the property is within easy reach of both Angel station (Northern line) and Highbury & Islington station (Victoria line, overground and National Rail services). The property is also located within the catchment area of William Tyndale School and Canonbury School.



Canonbury Mansions, Canonbury Place, N1

○ - Ceiling Height



This plan is for guidance only and must not be relied upon as a statement of fact. Attention is drawn to the important notice on the last page of the text of the Particulars.

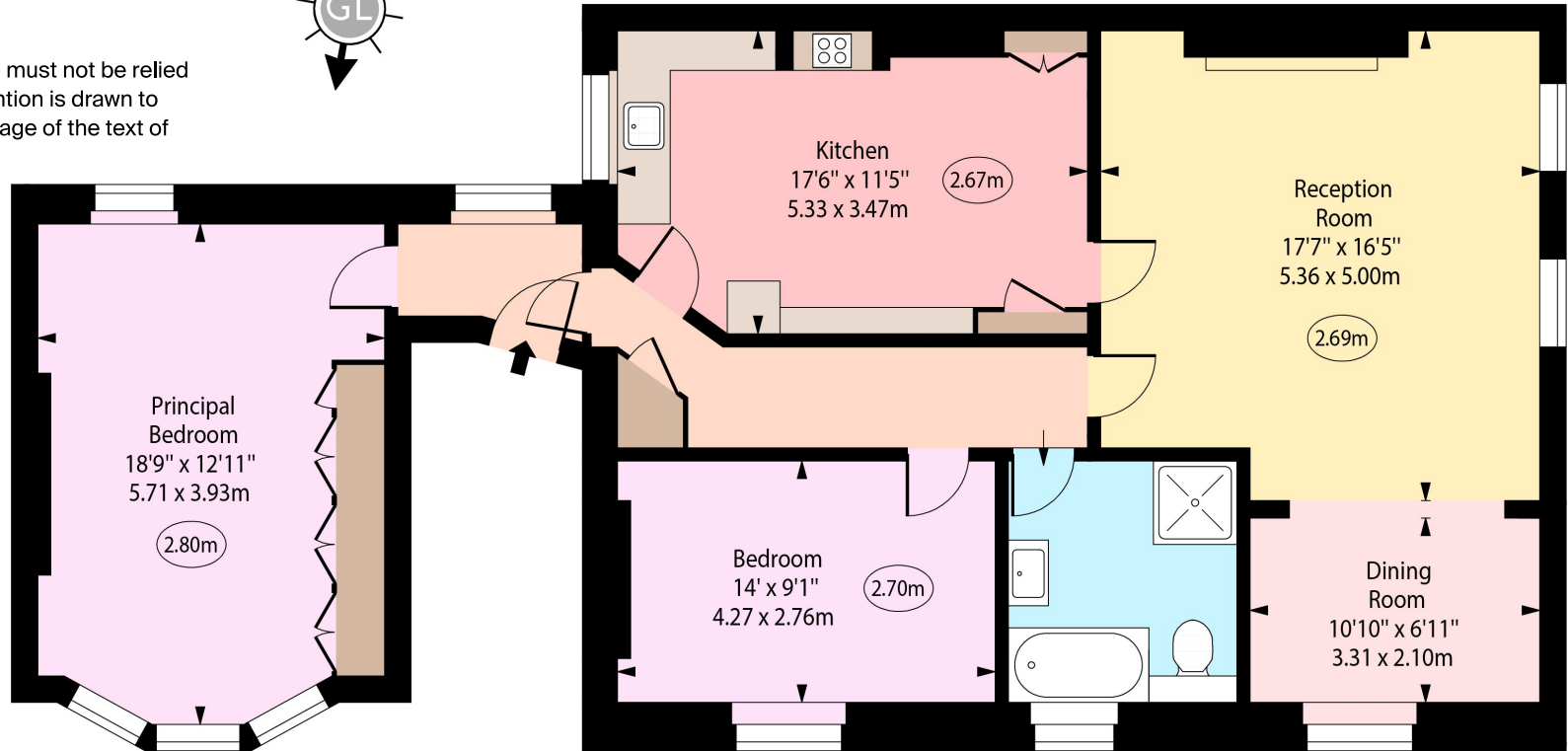

Second Floor

Approx Gross Internal Area 1130 Sq Ft - 104.98 Sq M

Knight Frank
Islington & King's Cross
Sales
321-322 Upper Street
London N1 2XQ
knightfrank.co.uk

I would be delighted to tell you more
Sebastian Toy
+44 20 3657 7348
sebastian.toy@knightfrank.com



Fixtures and fittings: A list of the fitted carpets, curtains, light fittings and other items fixed to the property which are included in the sale (or may be available by separate negotiation) will be provided by the Seller's Solicitors.
Important Notice: 1. Particulars: These particulars are not an offer or contract, nor part of one. You should not rely on statements by Knight Frank LLP in the particulars or by word of mouth or in writing ("information") as being factually accurate about the property, its condition or its value. Neither Knight Frank LLP nor any joint agent has any authority to make any representations about the property, and accordingly any information given is entirely without responsibility on the part of the agents, seller(s) or lessor(s). 2. Photos, Videos etc: The photographs, property videos and virtual viewings etc. show only certain parts of the property as they appeared at the time they were taken. Areas, measurements and distances given are approximate only. 3. Regulations etc: Any reference to alterations to, or use of, any part of the property does not mean that any necessary planning, building regulations or other consent has been obtained. A buyer or lessee must find out by inspection or in other ways that these matters have been properly dealt with and that all information is correct. 4. VAT: The VAT position relating to the property may change without notice. 5. To find out how we process Personal Data, please refer to our Group Privacy Statement and other notices at <https://www.knightfrank.com/legals/privacy-statement>.
Particulars dated July 2024. Photographs and videos dated July 2024.
Knight Frank is the trading name of Knight Frank LLP. Knight Frank LLP is a limited liability partnership registered in England and Wales with registered number OC305934. Our registered office is at 55 Baker Street, London W1U 8AN where you may look at a list of members' names. If we use the term 'partner' when referring to one of our representatives, that person will either be a member, employee, worker or consultant of Knight Frank LLP and not a partner in a partnership. If you do not want us to contact you further about our services then please contact us by either calling 020 3544 0692, email to marketing.help@knightfrank.com or post to our UK Residential Marketing Manager at our registered office (above) providing your name and address.