



Robinswood Mews, Highbury Fields, London N5



Robinswood Mews, Highbury Fields N5

A contemporary and immaculately presented detached family home offering around 1,600 sq ft of beautifully presented accommodation, a garden and private parking in Robinswood Mews, a quiet private Mews accessed via Highbury Crescent and only moments from the greenery of Highbury Fields.



Guide price: £1,895,000

Tenure: Available freehold

Local authority: London Borough of Islington

Council tax band: G





Arranged over three floors with a modern, contemporary feel throughout, the property features impressive living space, including a bright, open-plan kitchen/dining room on the ground floor with doors leading to the garden. There is also an open-plan kitchen with fitted appliances and a guest cloakroom/laundry room on this floor.

On the first floor, there is a further, spacious reception room, along with a lovely home office flooded with natural light due to its dual-aspect window overlooking the peaceful mews. The luxurious principal bedroom suite, also on the first floor, includes an en suite bathroom with a walk-in shower, built-in wardrobes and a private balcony overlooking the garden.

There are three further double bedrooms and a family bathroom on the second floor.

There is also off street parking for one car on the private driveway next to the house.



Location

Robinswood Mews is supremely well placed for the greenery and amenities of Highbury Fields (gym, tennis courts, etc), the shops of Highbury Barn including the renowned Godfreys butchers, fishmongers and Da Marios delicatessen. Transport can be found locally at Highbury & Islington station (National Rail, Victoria Line & London Overground), along with Arsenal Underground (Piccadilly Line) Canonbury Station (London Overground), with a number of bus routes running along Highbury Grove. The delights of Trullo & Prawn On The Lawn, by Highbury Corner, offer superb local dining.



Robinswood Mews, N5



○ - Ceiling Height

This plan is for guidance only and must not be relied upon as a statement of fact. Attention is drawn to the important notice on the last page of the text of the Particulars.

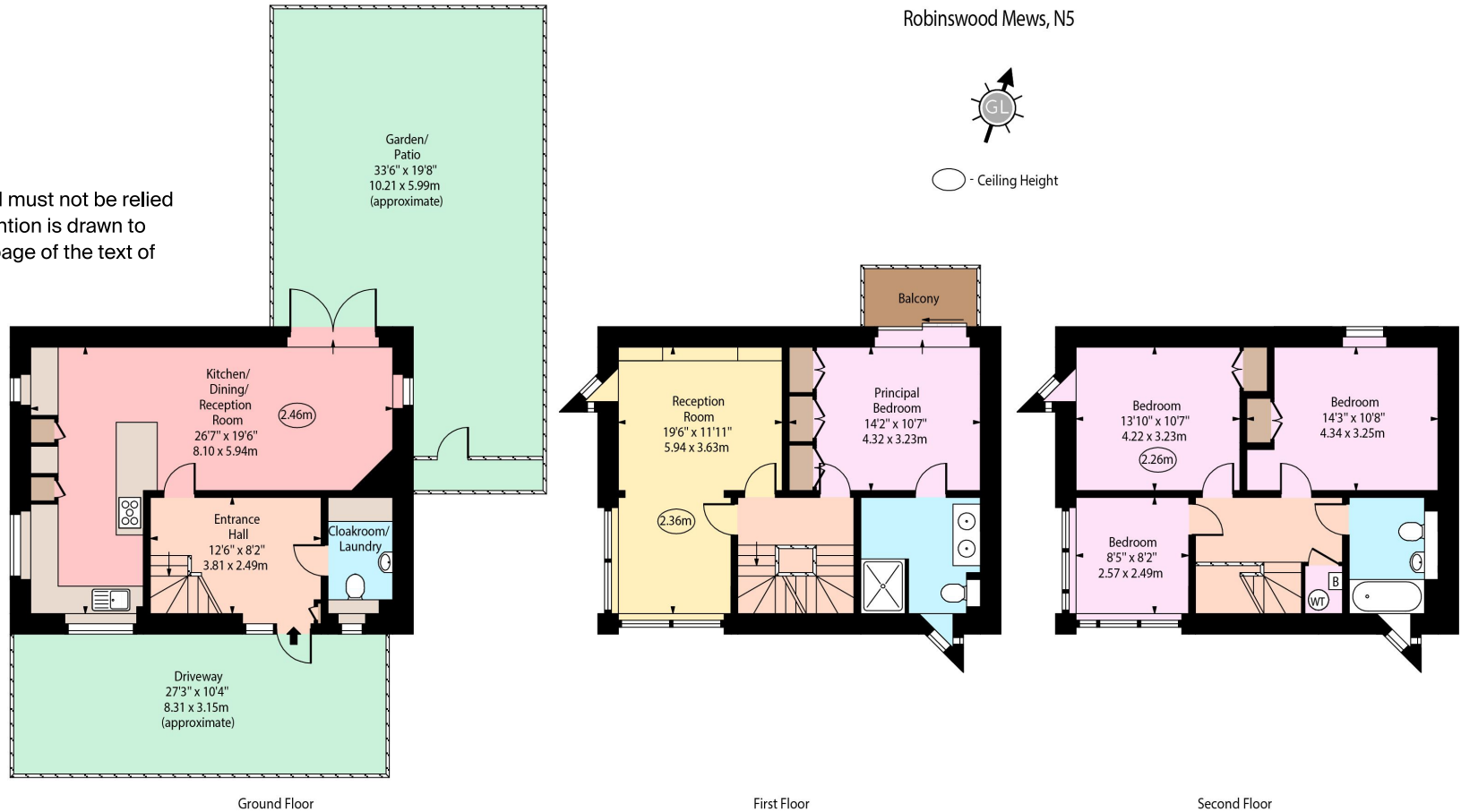

Approx Gross Internal Area 1574 Sq Ft - 146.22 Sq M

Knight Frank
Islington & King's Cross

Sales
321-322 Upper Street
London N1 2XQ
knightfrank.co.uk

I would be delighted to tell you more

Chelsea Whelan
+44 20 3910 9736
chelsea.whelan@knightfrank.com



Fixtures and fittings: A list of the fitted carpets, curtains, light fittings and other items fixed to the property which are included in the sale (or may be available by separate negotiation) will be provided by the Seller's Solicitors.

Important Notice: 1. Particulars: These particulars are not an offer or contract, nor part of one. You should not rely on statements by Knight Frank LLP in the particulars or by word of mouth or in writing ("information") as being factually accurate about the property, its condition or its value. Neither Knight Frank LLP nor any joint agent has any authority to make any representations about the property, and accordingly any information given is entirely without responsibility on the part of the agents, seller(s) or lessor(s). 2. Photos, Videos etc: The photographs, property videos and virtual viewings etc. show only certain parts of the property as they appeared at the time they were taken. Areas, measurements and distances given are approximate only. 3. Regulations etc: Any reference to alterations to, or use of, any part of the property does not mean that any necessary planning, building regulations or other consent has been obtained. A buyer or lessee must find out by inspection or in other ways that these matters have been properly dealt with and that all information is correct. 4. VAT: The VAT position relating to the property may change without notice. 5. To find out how we process Personal Data, please refer to our Group Privacy Statement and other notices at <https://www.knightfrank.com/legals/privacy-statement>.

Particulars dated May 2024. Photographs and videos dated May 2024.

Knight Frank is the trading name of Knight Frank LLP. Knight Frank LLP is a limited liability partnership registered in England and Wales with registered number OC305934. Our registered office is at 55 Baker Street, London W1U 8AN where you may look at a list of members' names. If we use the term 'partner' when referring to one of our representatives, that person will either be a member, employee, worker or consultant of Knight Frank LLP and not a partner in a partnership. If you do not want us to contact you further about our services then please contact us by either calling 020 3544 0692, email to marketing.help@knightfrank.com or post to our UK Residential Marketing Manager at our registered office (above) providing your name and address.