

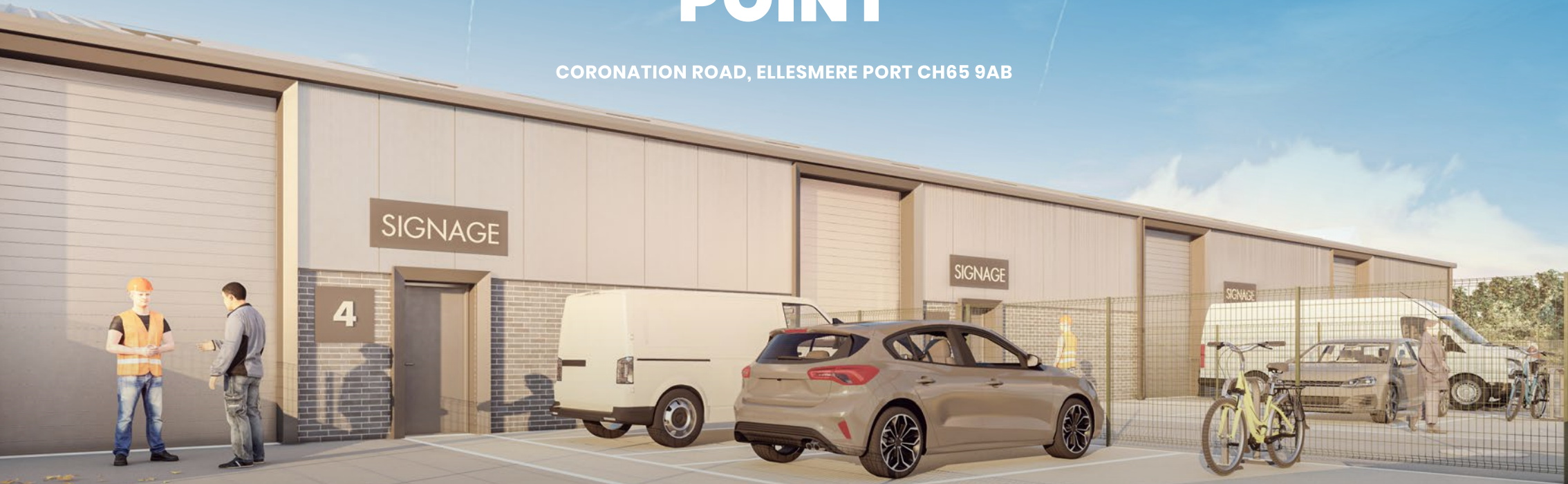

# CORONATION POINT

CORONATION ROAD, ELLESMERE PORT CH65 9AB



## FOR SALE / TO LET

6 NEW BUILD INDUSTRIAL UNITS

146 - 222 sq m (1,566 - 2,935 sq ft)

ENTER



## DESCRIPTION

Coronation Point is a brand new development of 6 high specification commercial units available for sale or to let. The units are available individually or as a combination, and provide a rare opportunity for businesses to owner occupy their premises.

# SPECIFICATION

- Kingspan profile cladding
- Steel portal frame
- Full height loading door
- 4.530m eaves height
- WC facilities
- On-site parking
- Provision for electric vehicle charging
- Electric roller shutter door

Potential for various occupier fitouts to include office fit outs, mezzanines and break-out spaces.

# UNITS

	sq m	sq ft
<b>Unit 1</b>	146	(1,571)
<b>Unit 2</b>	148	(1,591)
<b>Unit 3</b>	148	(1,595)
<b>Unit 4</b>	146	(1,566)
<b>Unit 5</b>	222	(2,395)
<b>Unit 6</b>	222	(2,393)

All areas based on gross internal area assumptions

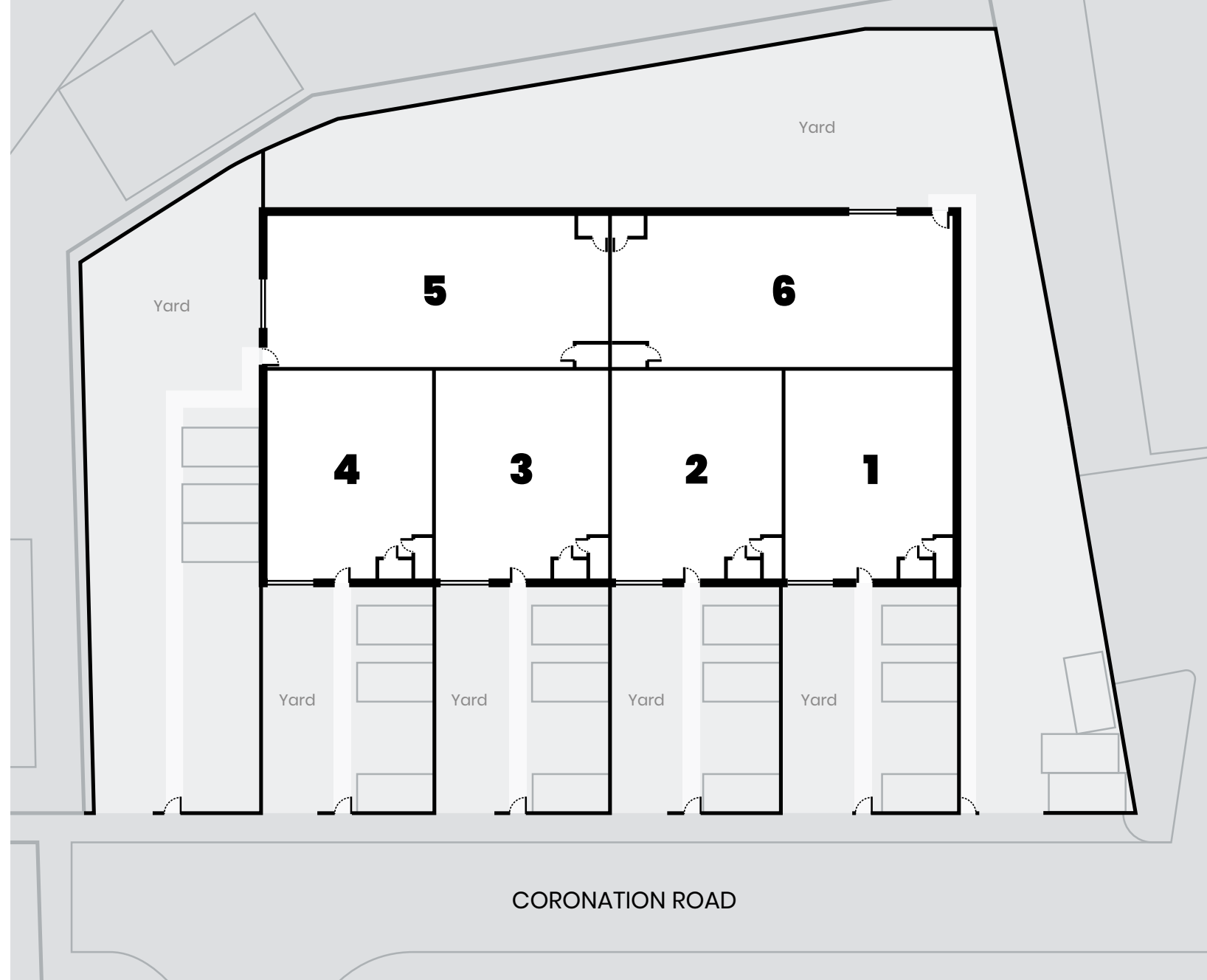

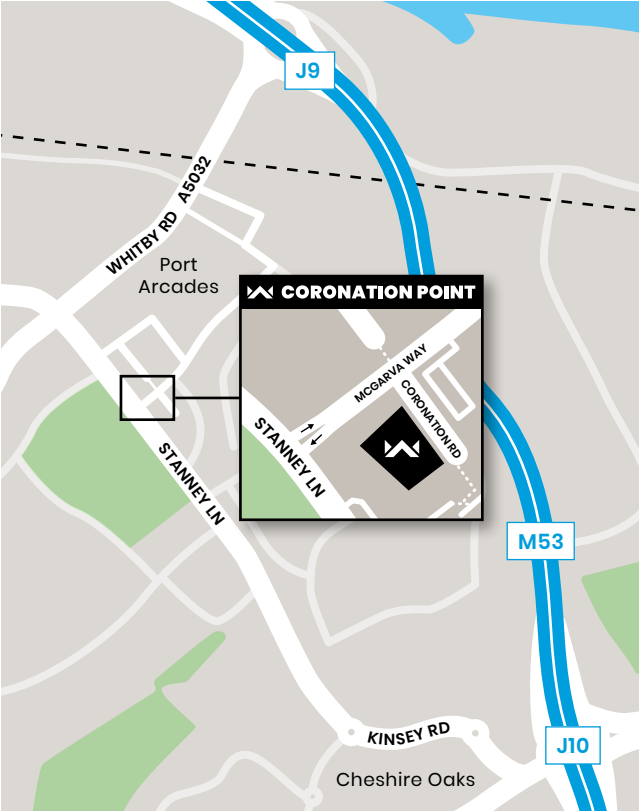

## LOCATION

Coronation Point is located at the end of Coronation Road, Ellesmere Port which is accessed off Stanney Lane. Junctions 9 and 10 of the M53 motorway are within 7 minutes drive away, providing easy access to the wider Cheshire and Merseyside area and the North West.

The surrounding area is a long established commercial/trade counter location with excellent amenities close by including Ellesmere Port Town Centre and Cheshire Oaks.

**SAT NAV: CH65 9AB**





## TERMS

The units are offered for sale on long leaseholds and are available individually or combined. Alternatively the units are offered on a to let basis. Terms available on request. Prices exclusive of but subject to VAT at the prevailing rate.

## ESTATE CHARGE

An estate charge is in place for the management of Coronation Point. Details available on request.

## LEGAL COSTS

All parties to bear their own legal costs.

## EPC

Available upon request.



# CONTACT

For further information contact the joint agents:



0151 255 0755

**Tim Garnett**

timgarnett@keppiemassie.com

0151 255 0755



**Tony O'Keefe**

tony.okeefe@lm6.co.uk

0151 541 2445

**Phil Morley**

phil.morley@lm6.co.uk

0151 541 2445

Misrepresentation Act 1967, Unfair Contract Terms Act 1977 The Property Misdescriptions Act 1991. These particulars are issued without any responsibility on the part of the agents and are not to be construed as containing any representation or fact upon which any person is entitled to rely. Neither the agents nor any person in their employ has any authority to make or give any representation or warranty whatsoever in relation to the property. Keppie Massie are not able to advise in relation to matters and obligations regarding fire combustibility, resistance or protection. Keppie Massie do not provide any assurances regarding current or future fire regulatory requirements in respect of the property and that may impact upon future occupation, safety or maintenance and associated costs. All interested parties should rely on their own enquiries in this respect. May 2021. Designed by Bella Design belladesign.co.uk

